

Circuits	Dimensions (mm)	
	A	B
10	5.00	12.50
12	6.25	13.75
14	7.50	15.00
20	11.25	18.75
30	17.50	25.00
40	23.75	31.25
50	30.00	37.50

### Specifications:

Current Rating: 1.0A AC/DC  
Voltage rating: 150V AC/DC  
Temperature range: -25°C to +85°C  
Contact resistance: 20mΩ max.  
Insulation resistance: 500MΩ min.  
Withstand voltage: 500V AC/minute  
Package: tape & reel

### Material:

Housing: nylon 9T, UL94V-0, beige  
PIN: brass  
Solder tab: brass

Mates with: 1252W-D (wire connector, dual row)

### Part Number Information:

**1252 BVS-D XX 09 BG G**

Series Number  
BVS-D: board conn, vertical, SMT, dual row  
No. of circuits, 10 to 50  
Material: 09 -- nylon 9T, UL94V-0  
Color: BG--beige  
Plating: G-- gold flash

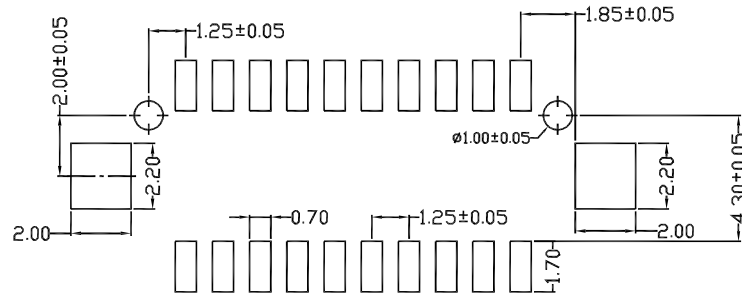
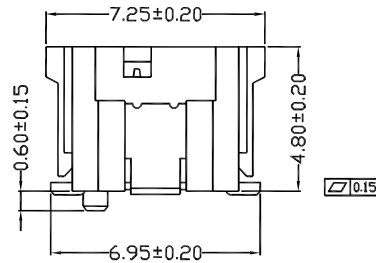
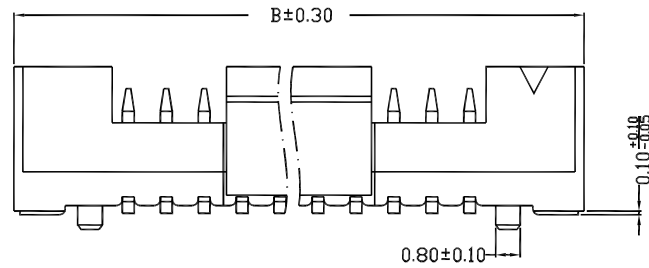
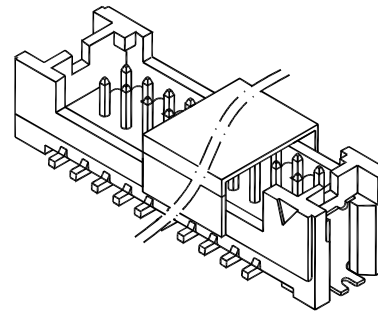
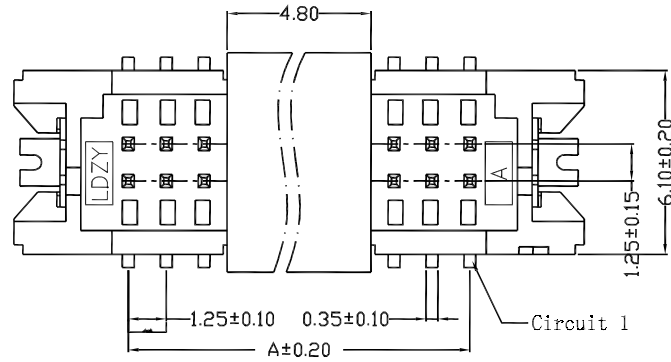

**P.C.B. LAYOUT**

							General Tolerance	<b>Zeakka Electronics</b>				Document No.: ZK-1252BVS-D		
							.X ±0.3					Title: HEADER, VERTICAL, SMT TYPE, DUAL ROW, 1.25MM PITCH, GOLD FLASH		
							.XX ±0.2	APPR	CH'K	DRWN	Date	Dimensions	Scale	Version
Date	Version	EC No.	Description	DRWN	CH'K	APPR	.XXX ±0.1	Kai Lee	Cris Wang	Jun Wei	2020.8.8	mm	1:1	A
							THIRD ANGLE PROJECTION							

Circuits	Dimensions (mm)	
	A	B
10	5.00	10.40
12	6.25	11.65
14	7.50	12.90
20	11.25	16.65
30	17.50	22.90
40	23.75	29.15
50	30.00	35.40

**Specifications:**

Current Rating: 1.0A AC/DC  
Voltage rating: 150V AC/DC  
Temperature range: -25°C to +85°C  
Contact resistance: 30mΩ max.  
Insulation resistance: 500MΩ min.  
Withstand voltage: 500V AC/minute

**Material:**

Housing: nylon 66, UL94V-0, gray

**Mates with:** 1252BVS-D (header, vertical, SMT type, dual row)

**Used with:** 1252TF-PX (female terminal)

**Part Number Information:**

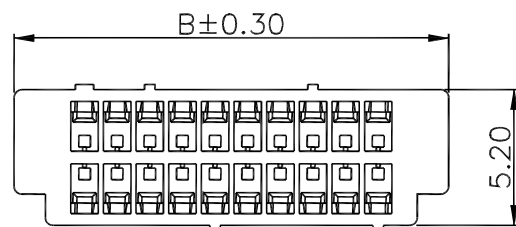
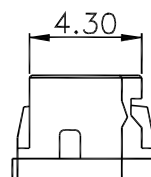
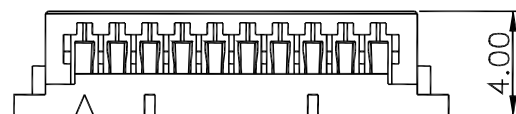
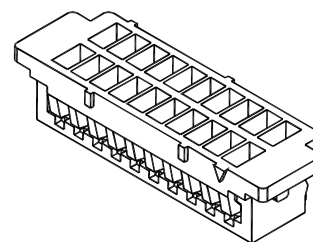
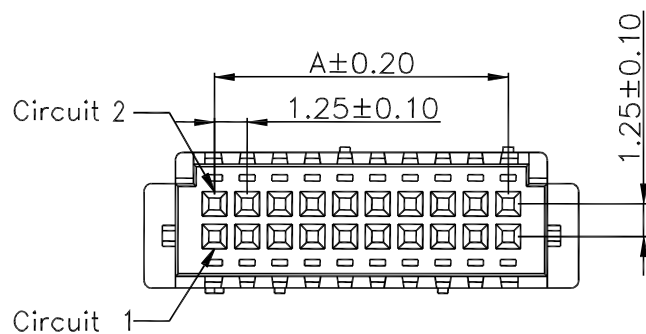
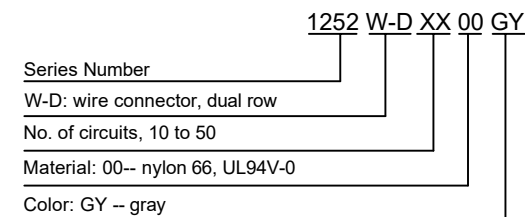

							General Tolerance	Zeakka Electronics				Document No.: ZK-1252W-D		
							.X ±0.3					Title: HOUSING, FEMALE, CRIMP TYPE, DUAL ROW, 1.25MM PITCH		
							.XX ±0.2	APPR	CH'K	DRWN	Date	Dimensions	Scale	Version
Date	Version	EC No.	Description	DRWN	CH'K	APPR	.XXX ±0.1	Kai Lee	Cris Wang	Jun Wei	2020.8.8	mm	1:1	A
							THIRD ANGLE PROJECTION							

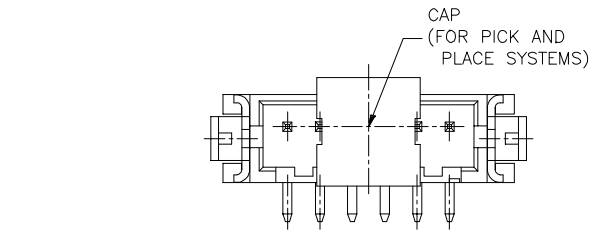

TO MAKE SURE THE CAP CAN BE PUT ON THE MIDPOINT FOR 04P TO 15P.

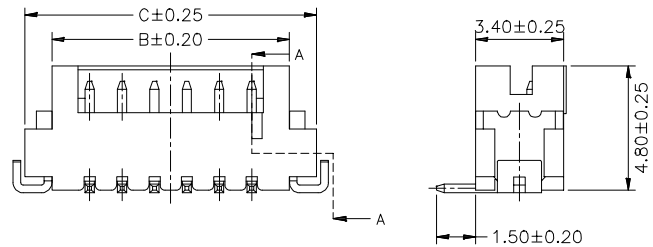
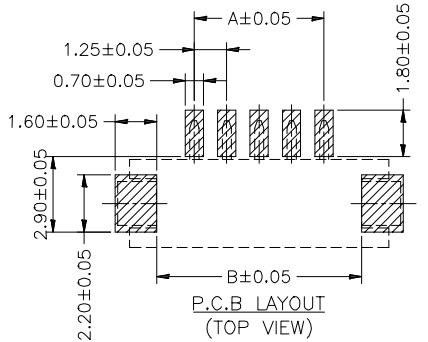
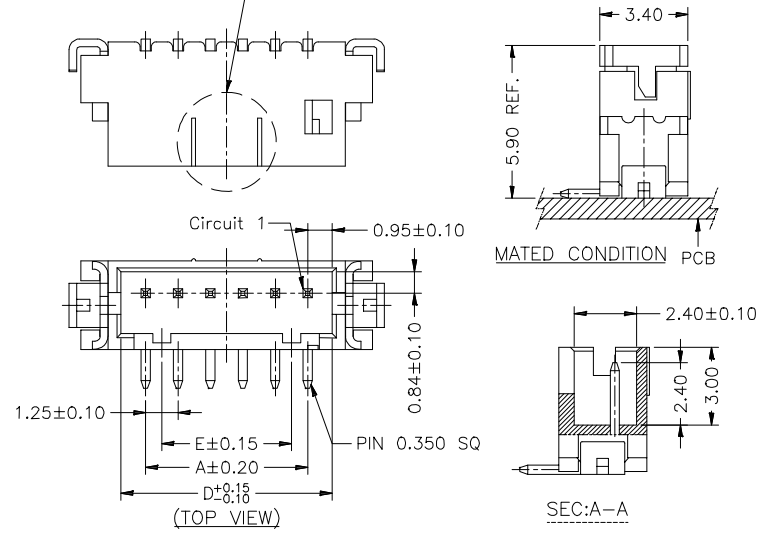
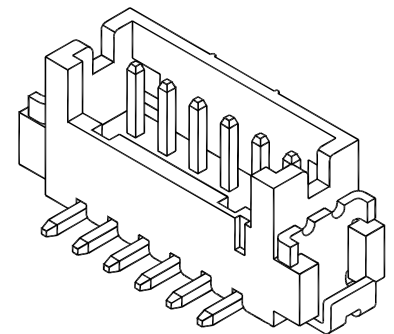

**Specifications:**

- Current Rating: 1.0A AC/DC
- Voltage rating: 150V AC/DC
- Temperature range: -25°C to +85°C
- Contact resistance: 30mΩ max.
- Insulation resistance: 500MΩ min.
- Withstand voltage: 500V AC/minute
- Package: tape & reel

**Material:**

- Housing: nylon 6T, UL94V-0, beige
- PIN: brass
- Solder tab: phosphor bronze

**Mates with:** 1252W-S (wire connector, single row)

**Part Number Information:**

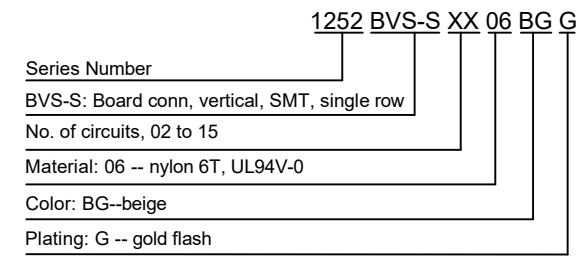

Circuits	Dimensions (mm)				
	A	B	C	D	E
2	1.25	4.15	6.25	3.15	/
3	2.50	5.40	7.50	4.40	1.25
4	3.75	6.65	8.75	5.65	2.50
5	5.00	7.90	10.00	6.90	3.75
6	6.25	9.15	11.25	8.15	5.00
7	7.50	10.40	12.50	9.40	6.25
8	8.75	11.65	13.75	10.65	7.50
9	10.00	12.90	15.00	11.90	8.75
10	11.25	14.15	16.25	13.15	10.00
11	12.50	15.40	17.50	14.40	11.25
12	13.75	16.65	18.75	15.65	12.50
13	15.00	17.90	20.00	16.90	13.75
14	16.25	19.15	21.25	18.15	15.00
15	17.50	20.40	22.50	19.40	16.25

							General Tolerance	Zeakka Electronics				Document No.: ZK-1252BVS-S		
							.X ±0.3					Title: HEADER, VERTICAL, SMT TYPE, SINGLE ROW, 1.25MM PITCH, GOLD FLASH		
							.XX ±0.2	APPR	CH'K	DRWN	Date	Dimensions	Scale	Version
Date	Version	EC No.	Description	DRWN	CH'K	APPR	.XXX ±0.1	Kai Lee	Cris Wang	Jun Wei	2020.8.8	mm	1:1	A
							THIRD ANGLE PROJECTION							

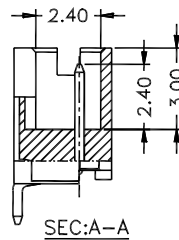
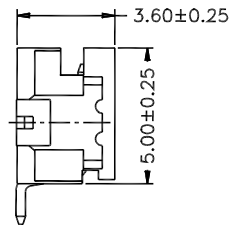
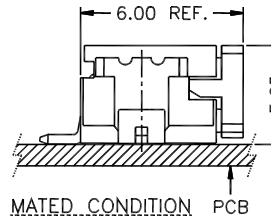
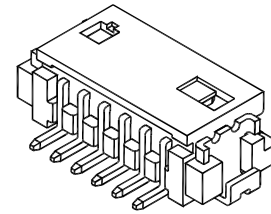
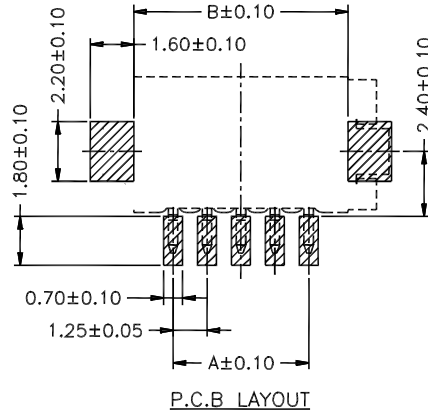
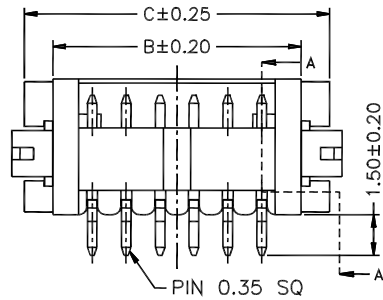
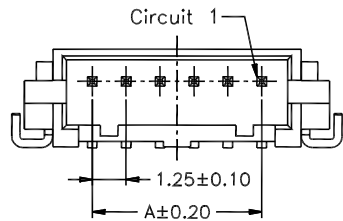
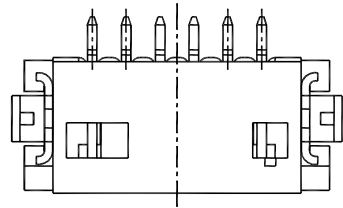

### Specifications:

Current Rating: 1.0A AC/DC  
 Voltage rating: 150V AC/DC  
 Temperature range: -25°C to +85°C  
 Contact resistance: 30mΩ max.  
 Insulation resistance: 500MΩ min.  
 Withstand voltage: 500V AC/minute  
 Package: tape & reel

### Material:

Housing: nylon 6T, UL94V-0, beige  
 PIN: brass  
 Solder tab: phosphor bronze

Mates with: 1252W-S (wire connector, single row)

Circuits	Dimensions (mm)		
	A	B	C
2	1.25	4.15	6.25
3	2.50	5.40	7.50
4	3.75	6.65	8.75
5	5.00	7.90	10.00
6	6.25	9.15	11.25
7	7.50	10.40	12.50
8	8.75	11.65	13.75
9	10.00	12.90	15.00
10	11.25	14.15	16.25
11	12.50	15.40	17.50
12	13.75	16.65	18.75
13	15.00	17.90	20.00
14	16.25	19.15	21.25
15	17.50	20.40	22.50

### Part Number Information:

Series Number: 1252 BRS - XX 06 BG G  
 BRS: Board conn, R/A, SMT type  
 No. of circuits, 02 to 15  
 Material: 06 -- nylon 6T, UL94V-0  
 Color: BG--beige  
 Plating: G -- gold flash

							General Tolerance	Zeakka Electronics				Document No.:	ZK-1252BRS		
							.X ±0.3					Title:	HEADER, R/A, SMT TYPE, SINGLE ROW, 1.25MM PITCH, GOLD FLASH		
							.XX ±0.2	APPR	CH'K	DRWN	Date	Dimensions	Scale	Version	
Date	Version	EC No.	Description	DRWN	CH'K	APPR	.XXX ±0.1	Kai Lee	Cris Wang	Jun Wei	2020.8.8	mm	1:1	A	
							THIRD ANGLE PROJECTION								

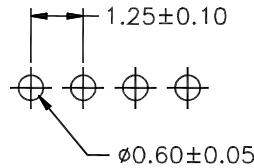
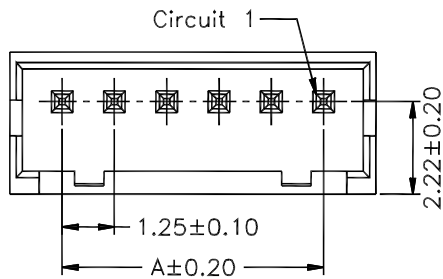
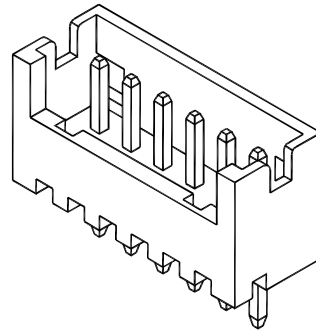
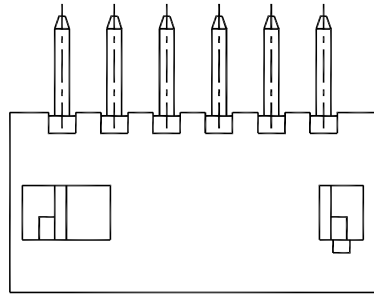

P.C.B LAYOUT

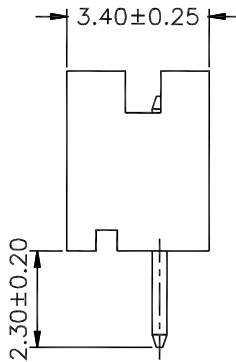
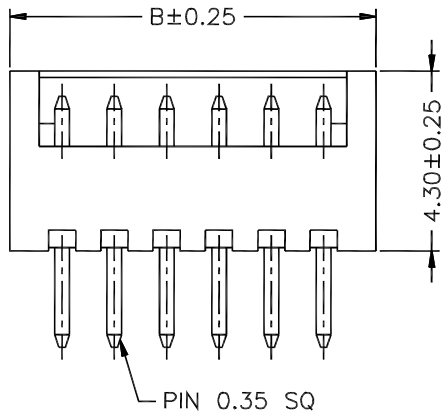

**Specifications:**

Current Rating: 1.0A AC/DC  
 Voltage rating: 150V AC/DC  
 Temperature range: -25°C to +85°C  
 Contact resistance: 30mΩ max.  
 Insulation resistance: 500MΩ min.  
 Withstand voltage: 500V AC/minute

**Material:**

Housing: nylon 6T, UL94V-0, gray  
 PIN: brass

Circuits	Dimensions (mm)	
	A	B
2	1.25	3.75
3	2.50	5.00
4	3.75	6.25
5	5.00	7.50
6	6.25	8.75
7	7.50	10.00
8	8.75	11.25
9	10.00	12.50
10	11.25	13.75
11	12.50	15.00
12	13.75	16.25
13	15.00	17.50
14	16.25	18.75
15	17.50	20.00

**Mates with:** 1252W-S (wire connector, single row)

**Part Number Information:**

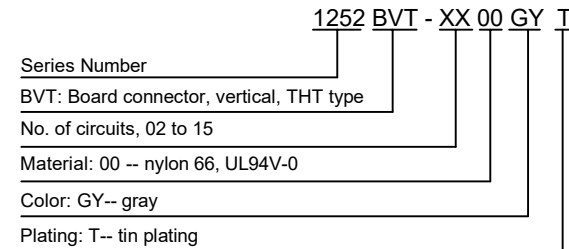

							General Tolerance	Zeakka Electronics				Document No.: ZK-1252BVT		
							.X ±0.3					Title: HEADER, VERTICAL, THT TYPE, SINGLE ROW, 1.25MM PITCH, TIN		
							.XX ±0.2	APPR	CH'K	DRWN	Date	Dimensions	Scale	Version
Date	Version	EC No.	Description	DRWN	CH'K	APPR	.XXX ±0.1	Kai Lee	Cris Wang	Jun Wei	2020.8.8	mm	1:1	A
							THIRD ANGLE PROJECTION							

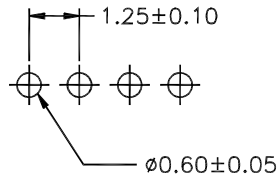
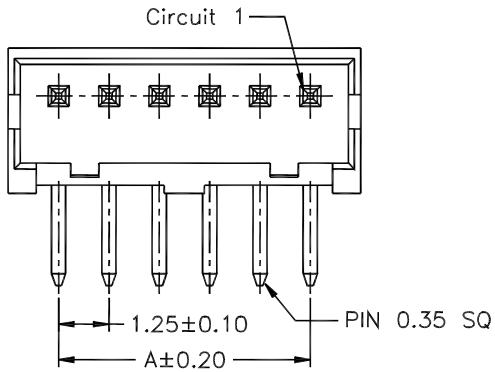
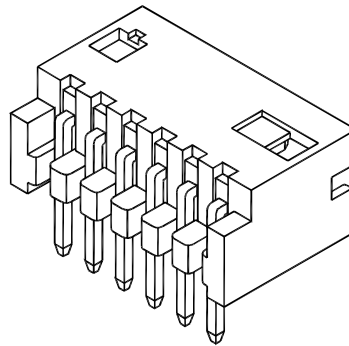
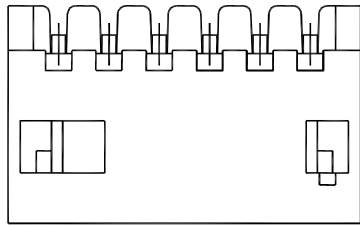

P.C.B LAYOUT

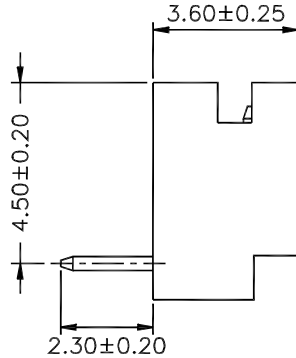
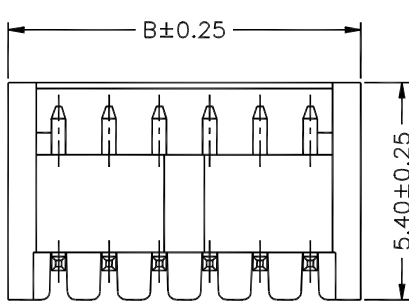

### Specifications:

Current Rating: 1.0A AC/DC  
 Voltage rating: 125V AC/DC  
 Temperature range: -25°C to +85°C  
 Contact resistance: 20mΩ max.  
 Insulation resistance: 100MΩ min.  
 Withstand voltage: 500V AC/minute

### Material:

Housing: nylon 6T, UL94V-0, gray  
 PIN: brass

Circuits	Dimensions (mm)	
	A	B
2	1.25	3.75
3	2.50	5.00
4	3.75	6.25
5	5.00	7.50
6	6.25	8.75
7	7.50	10.00
8	8.75	11.25
9	10.00	12.50
10	11.25	13.75
11	12.50	15.00
12	13.75	16.25
13	15.00	17.50
14	16.25	18.75
15	17.50	20.00

Mates with: 1252W-S (wire connector, single row)

### Part Number Information:

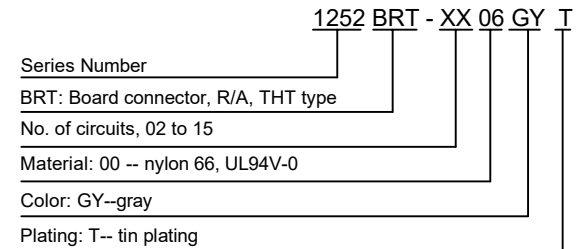

							General Tolerance	Zeakka Electronics				Document No.: ZK-1252BRT		
							.X ±0.3					Title: HEADER, R/A, THT TYPE, SINGLE ROW, 1.25MM PITCH, TIN		
							.XX ±0.2	APPR	CH'K	DRWN	Date	Dimensions	Scale	Version
Date	Version	EC No.	Description	DRWN	CH'K	APPR	.XXX ±0.1	Kai Lee	Cris Wang	Jun Wei	2020.8.8	mm	1:1	A
							THIRD ANGLE PROJECTION							

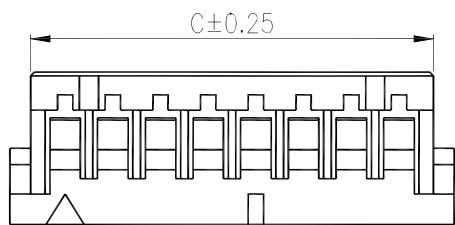
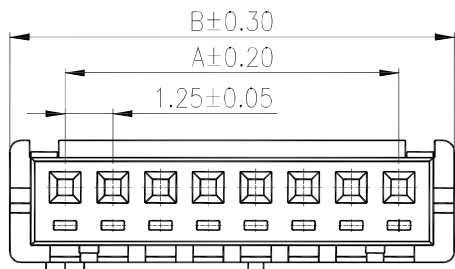

Circuit 1

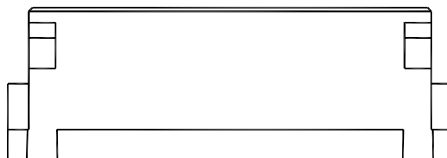
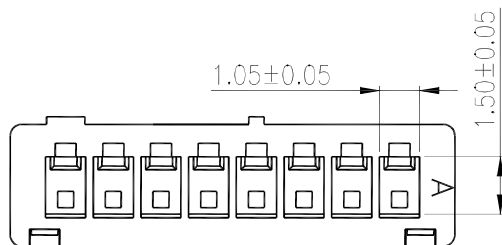
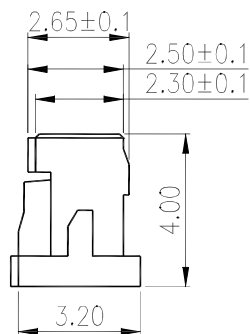

### Specifications:

Current Rating: 1.0A AC/DC  
 Voltage rating: 150V AC/DC  
 Temperature range: -25°C to +85°C  
 Contact resistance: 30mΩ max.  
 Insulation resistance: 500MΩ min.  
 Withstand voltage: 500V AC/minute

### Material:

Housing: nylon 66, UL94V-0, gray

### Mates with:

1252BVS-S (board connector, vertical, SMT, single row)  
 1252BRS (board connector, R/A, SMT)  
 1252BVT (board connector, vertical, Through Hole)  
 1252BRT (board connector, R/A, Through Hole)

### Used with:

1252TF-PX (male terminal)

### Part Number Information:

1252 W-S XX 00 GY

Series Number  
 W-S: wire connector, single row  
 No. of circuits, 02 to 15  
 Material: 00-- nylon 66, UL94V-0  
 Color: GY -- gray

Circuits	Dimensions (mm)		
	A	B	C
2	1.25	4.15	3.05
3	2.50	5.40	4.30
4	3.75	6.65	5.55
5	5.00	7.90	6.80
6	6.25	9.15	8.05
7	7.50	10.40	9.30
8	8.75	11.65	10.55
9	10.00	12.90	11.80
10	11.25	14.15	13.05
11	12.50	15.40	14.30
12	13.75	16.65	15.55
13	15.00	17.90	16.80
14	16.25	19.15	18.05
15	17.50	20.40	19.30

							General Tolerance	Zeakka Electronics				Document No.: ZK-1252W-S		
							.X ±0.3					Title: HOUSING, FEMALE, CRIMP TYPE, SINGLE ROW, 1.25MM PITCH		
							.XX ±0.2	APPR	CH'K	DRWN	Date	Dimensions	Scale	Version
Date	Version	EC No.	Description	DRWN	CH'K	APPR	.XXX ±0.1	Kai Lee	Cris Wang	Jun Wei	2020.8.8	mm	1:1	A
							THIRD ANGLE PROJECTION							

**Specifications:**

Current Rating: 1.0A AC/DC  
 Voltage rating: 150V AC/DC  
 Temperature range: -25°C to +85°C  
 Contact resistance: 30mΩ max.  
 Insulation resistance: 500MΩ min.  
 Withstand voltage: 500V AC/minute  
 Applicable wire: AWG30 - AWG26  
 Insulation OD: max 1.0mm

**Material:**

Phosphor bronze

**Used with:** 1252W-S (wire connector, single row)  
 1252W-D (wire connector, dual row)

**Part Number Information:**

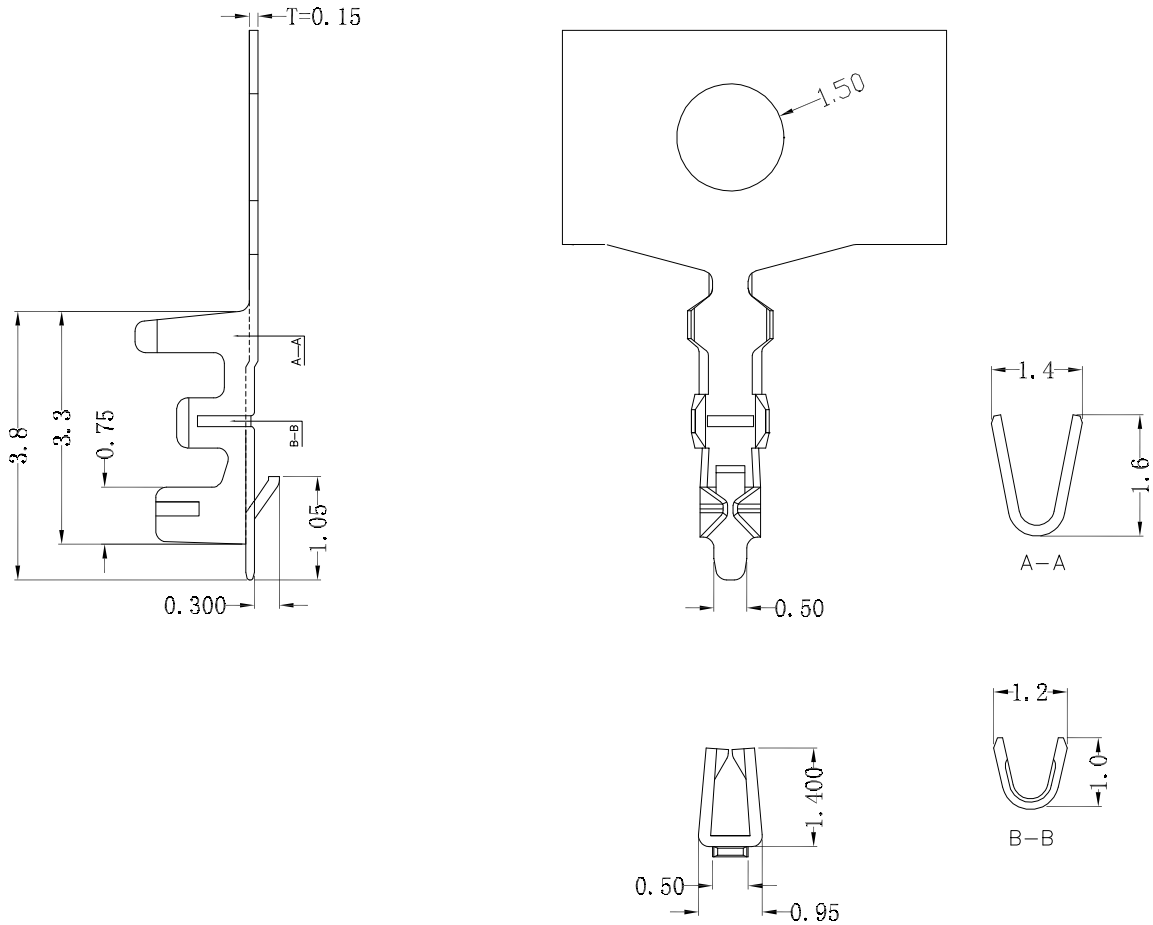
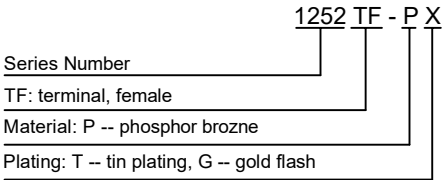

							General Tolerance	<h1>Zeakka Electronics</h1>				Document No.: ZK-1252TF						
							.X ±0.3					Title: TERMINAL, FEMALE, CRIMP TYPE, PHOSPHOR BRONZE, REEL						
							.XX ±0.2					APPR	CH'K	DRWN	Date	Dimensions	Scale	Version
							.XXX ±0.1					Kai Lee	Cris Wang	Jun Wei	2020.8.8	mm	1:1	A
Date	Version	EC No.	Description	DRWN	CH'K	APPR	THIRD ANGLE PROJECTION											