

2P

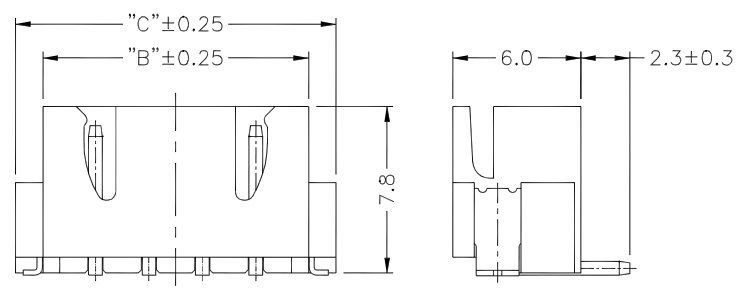

3P~16P

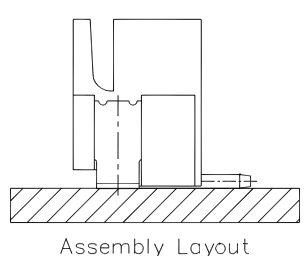

Assembly Layout

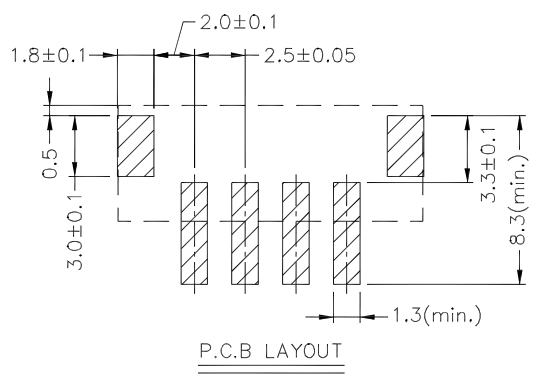

P.C.B LAYOUT

Specifications:

Current Rating: 3.0A AC/DC
 Voltage rating: 250V AC/DC
 Temperature range: -25°C to +85°C
 Contact resistance: 20mΩ max.
 Insulation resistance: 1000MΩ min.
 Withstand voltage: 1000V AC/minute
 Package: tape & reel

Material:

Housing: nylon 9T, UL94V-0, beige
 PIN: brass
 Solder tab: brass

Circuits	Dimensions (mm)		
	A	B	C
2	2.50	7.45	10.00
3	5.00	9.95	12.50
4	7.50	12.45	15.00
5	10.00	14.95	17.50
6	12.50	17.45	20.00
7	15.00	19.95	22.50
8	17.50	22.45	25.00
9	20.00	24.95	27.50
10	22.50	27.45	30.00
11	25.00	29.95	32.50
12	27.50	32.45	35.00
13	30.00	34.95	37.50
14	32.50	37.45	40.00
15	35.00	39.95	42.50
16	37.50	42.45	45.00

Mates with: 2501WF (wire connector, female, single row)

Part Number Information:

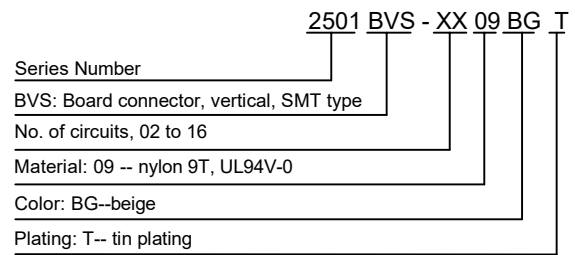

							General Tolerance	Zeakka Electronics				Document No.: ZK-2501BVS		
							.X ±0.3					Title: HEADER, VERTICAL, SMT TYPE, SINGLE ROW, 2.5MM PITCH, TIN		
							.XX ±0.2	APPR	CH'K	DRWN	Date	Dimensions	Scale	Version
Date	Version	EC No.	Description	DRWN	CH'K	APPR	.XXX ±0.1	Kai Lee	Cris Wang	Jun Wei	2020.8.8	mm	1:1	A
							THIRD ANGLE PROJECTION							

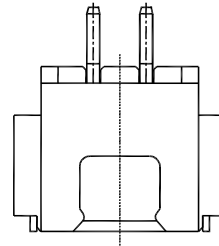
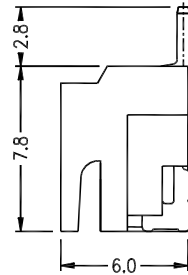
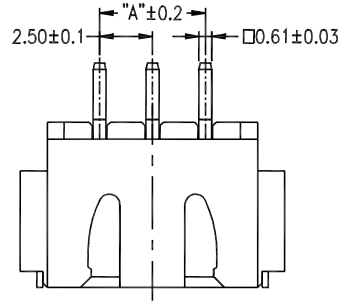
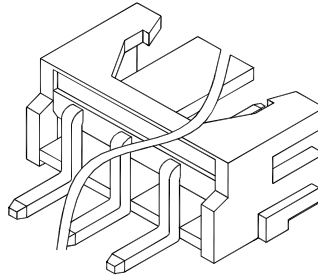
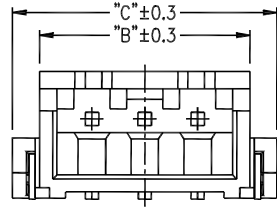

2P

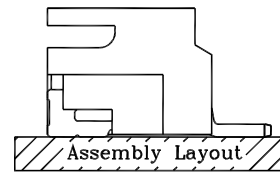
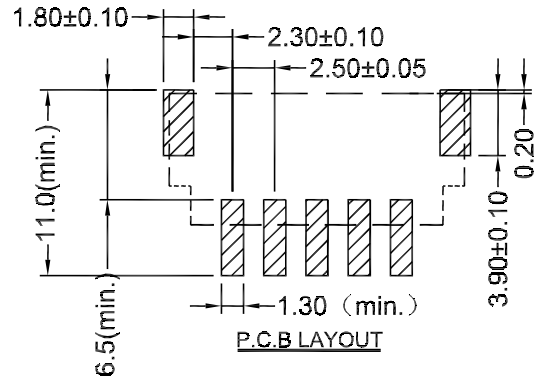

Specifications:

Current Rating: 3.0A AC/DC
 Voltage rating: 250V AC/DC
 Temperature range: -25°C to +85°C
 Contact resistance: 20mΩ max.
 Insulation resistance: 1000MΩ min.
 Withstand voltage: 1000V AC/minute
 Package: tape & reel

Material:

Housing: nylon 9T, UL94V-0, beige
 PIN: brass
 Solder tab: brass

Circuits	Dimensions (mm)		
	A	B	C
2	2.50	7.45	10.00
3	5.00	9.95	12.50
4	7.50	12.45	15.00
5	10.00	14.95	17.50
6	12.50	17.45	20.00
7	15.00	19.95	22.50
8	17.50	22.45	25.00
9	20.00	24.95	27.50
10	22.50	27.45	30.00
11	25.00	29.95	32.50
12	27.50	32.45	35.00
13	30.00	34.95	37.50
14	32.50	37.45	40.00
15	35.00	39.95	42.50
16	37.50	42.45	45.00

Mates with: 2501WF (wire connector, female, single row)

Part Number Information:

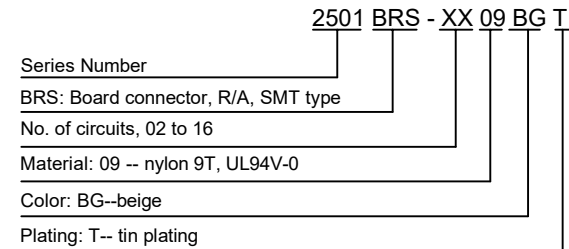

							General Tolerance	Zeakka Electronics				Document No.:	ZK-2501BRS		
							.X ±0.3					Title:	HEADER, R/A, SMT TYPE, SINGLE ROW, 2.5MM PITCH, TIN		
							.XX ±0.2	APPR	CH'K	DRWN	Date	Dimensions	Scale	Version	
Date	Version	EC No.	Description	DRWN	CH'K	APPR	.XXX ±0.1	Kai Lee	Cris Wang	Jun Wei	2020.8.8	mm	1:1	A	
							THIRD ANGLE PROJECTION								

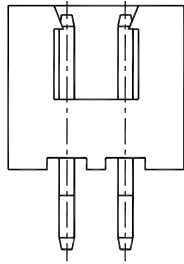

02P

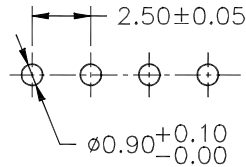
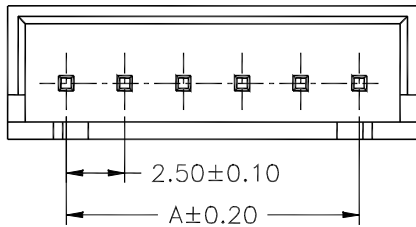
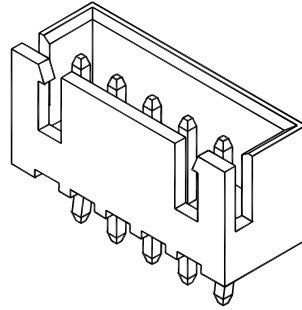

P.C.B LAYOUT

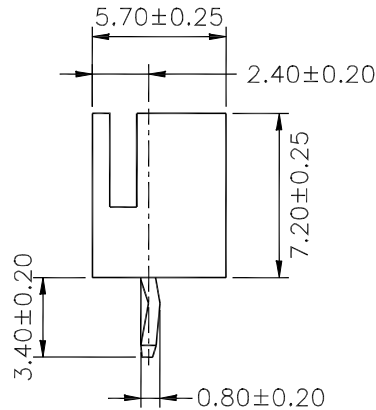
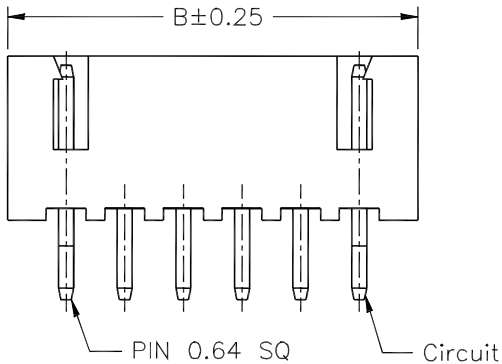

Specifications:

Current Rating: 3.0A AC/DC
 Voltage rating: 250V AC/DC
 Temperature range: -25°C to +85°C
 Contact resistance: 10mΩ max.
 Insulation resistance: 1000MΩ min.
 Withstand voltage: 1000V AC/minute

Material:

Housing: nylon 66, UL94V-0, white
 PIN: brass

Circuits	Dimensions (mm)	
	A	B
2	2.50	7.50
3	5.00	10.00
4	7.50	12.50
5	10.00	15.00
6	12.50	17.50
7	15.00	20.00
8	17.50	22.50
9	20.00	25.00
10	22.50	27.50
11	25.00	30.00
12	27.50	32.50
13	30.00	35.00
14	32.50	37.50
15	35.00	40.00
16	37.50	42.50
17	40.00	45.00
18	42.50	47.50
19	45.00	50.00
20	47.50	52.50

Mates with: 2501WF (wire connector, female, single row)

Part Number Information:

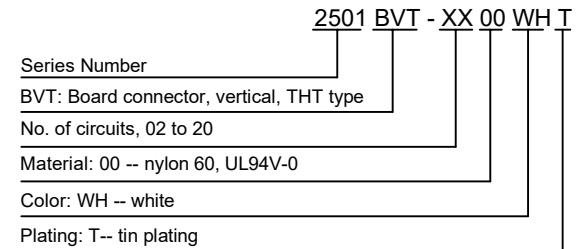

							General Tolerance	Zeakka Electronics				Document No.: ZK-2501BVT		
							.X ±0.3					Title: HEADER, VERTICAL, THT TYPE, SINGLE ROW, 2.5MM PITCH, TIN		
							.XX ±0.2	APPR	CH'K	DRWN	Date	Dimensions	Scale	Version
Date	Version	EC No.	Description	DRWN	CH'K	APPR	.XXX ±0.1	Kai Lee	Cris Wang	Jun Wei	2020.8.8	mm	1:1	A
							THIRD ANGLE PROJECTION							

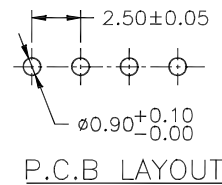
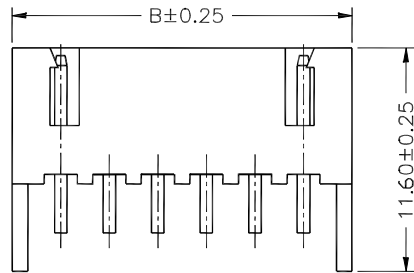
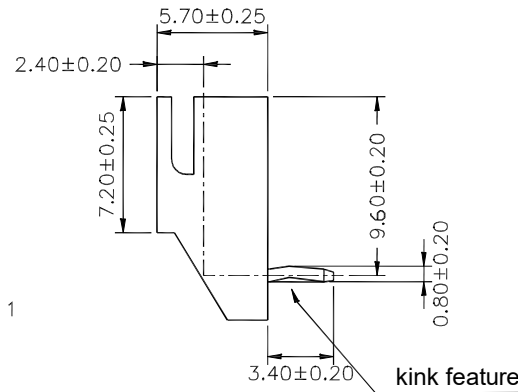
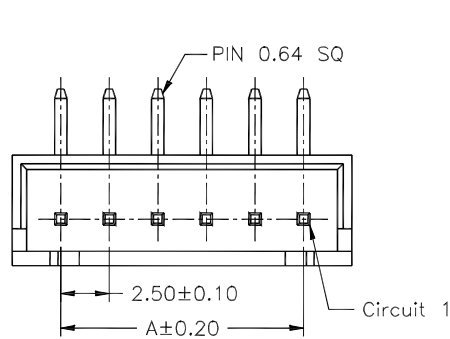
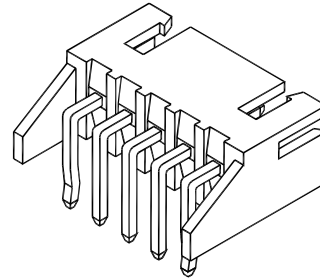
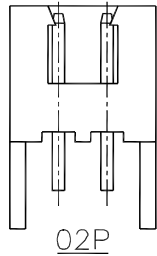

Specifications:

Current Rating: 3.0A AC/DC
 Voltage rating: 250V AC/DC
 Temperature range: -25°C to +85°C
 Contact resistance: 10mΩ max.
 Insulation resistance: 1000MΩ min.
 Withstand voltage: 1000V AC/minute

Material:

Housing: nylon 66, UL94V-0, white
 PIN: brass

Circuits	Dimensions (mm)	
	A	B
2	2.50	7.50
3	5.00	10.00
4	7.50	12.50
5	10.00	15.00
6	12.50	17.50
7	15.00	20.00
8	17.50	22.50
9	20.00	25.00
10	22.50	27.50
11	25.00	30.00
12	27.50	32.50
13	30.00	35.00
14	32.50	37.50
15	35.00	40.00
16	37.50	42.50
17	40.00	45.00
18	42.50	47.50
19	45.00	50.00
20	47.50	52.50

Mates with: 2501WF (wire connector, female, single row)

Part Number Information:

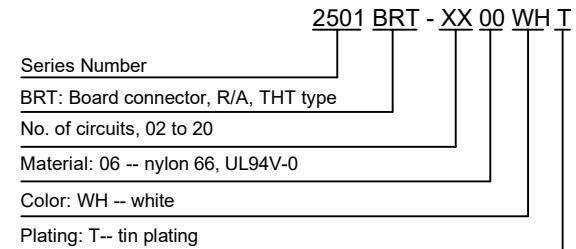

							General Tolerance	Zeakka Electronics				Document No.: ZK-2501BRT		
							.X ±0.3					Title: HEADER, R/A, THT TYPE, SINGLE ROW, 2.5MM PITCH, TIN		
							.XX ±0.2	APPR	CH'K	DRWN	Date	Dimensions	Scale	Version
Date	Version	EC No.	Description	DRWN	CH'K	APPR	.XXX ±0.1	Kai Lee	Cris Wang	Jun Wei	2020.8.8	mm	1:1	A
							THIRD ANGLE PROJECTION							

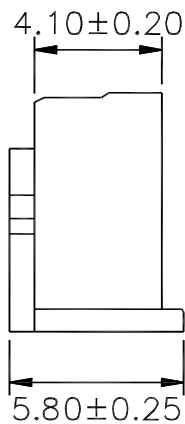
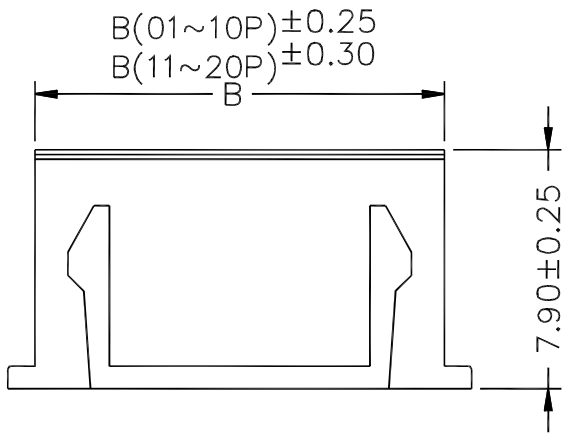
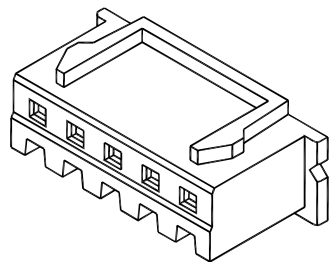
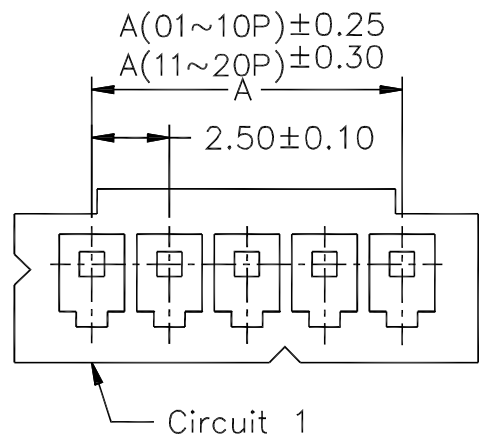

Specifications:

Current Rating: 3.0A AC/DC
 Voltage rating: 250V AC/DC
 Temperature range: -25°C to +85°C
 Contact resistance: 20mΩ max.
 Insulation resistance: 1000MΩ min.
 Withstand voltage: 1000V AC/minute

Circuits	Dimensions (mm)	
	A	B
2	2.50	5.70
3	5.00	8.20
4	7.50	10.70
5	10.00	13.20
6	12.50	15.70
7	15.00	18.20
8	17.50	20.70
9	20.00	23.20
10	22.50	25.70
11	25.00	28.20
12	27.50	30.70
13	30.00	33.20
14	32.50	35.70
15	35.00	38.20
16	37.50	40.70
17	40.00	43.20
18	42.50	45.70
19	45.00	48.20
20	47.50	50.70

Material:

Housing: nylon 66, UL94V-0, white

Mates with: 2501BVT (header, vertical, THT type)
 2501BRT (header, R/A, THT type)
 2501BVS (header, vertical, SMT type)
 2501BRS (header, R/A, SMT type)
 2501WM (wire connector, male)

Used with: 2501TF-PT (female terminal)

Part Number Information:

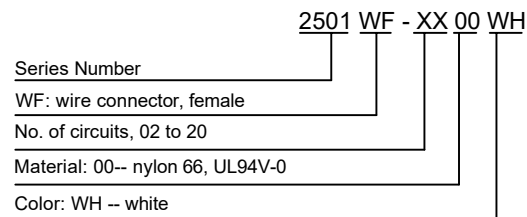

							General Tolerance	Zeakka Electronics				Document No.: ZK-2501WF		
							.X ±0.3					Title: HOUSING, FEMALE, CRIMP TYPE, SINGLE ROW, 2.5MM PITCH		
							.XX ±0.2	APPR	CH'K	DRWN	Date	Dimensions	Scale	Version
Date	Version	EC No.	Description	DRWN	CH'K	APPR	.XXX ±0.1	Kai Lee	Cris Wang	Jun Wei	2020.8.8	mm	1:1	A
							THIRD ANGLE PROJECTION							

Specifications:

Current Rating: 3.0A AC/DC
 Voltage rating: 250V AC/DC
 Temperature range: -25°C to +85°C
 Contact resistance: 30mΩ max.
 Insulation resistance: 1000MΩ min.
 Withstand voltage: 1000V AC/minute
 Applicable wire: AWG28 - AWG22
 Insulation OD: max 1.63mm

Material:

Phosphor bronze

Used with: 2501WF (wire connector, female)

Part Number Information:

2501 TF - P T

Series Number _____
 TF: terminal, female _____
 Material: P -- phosphor bronze _____
 Plating: T -- tin plating _____

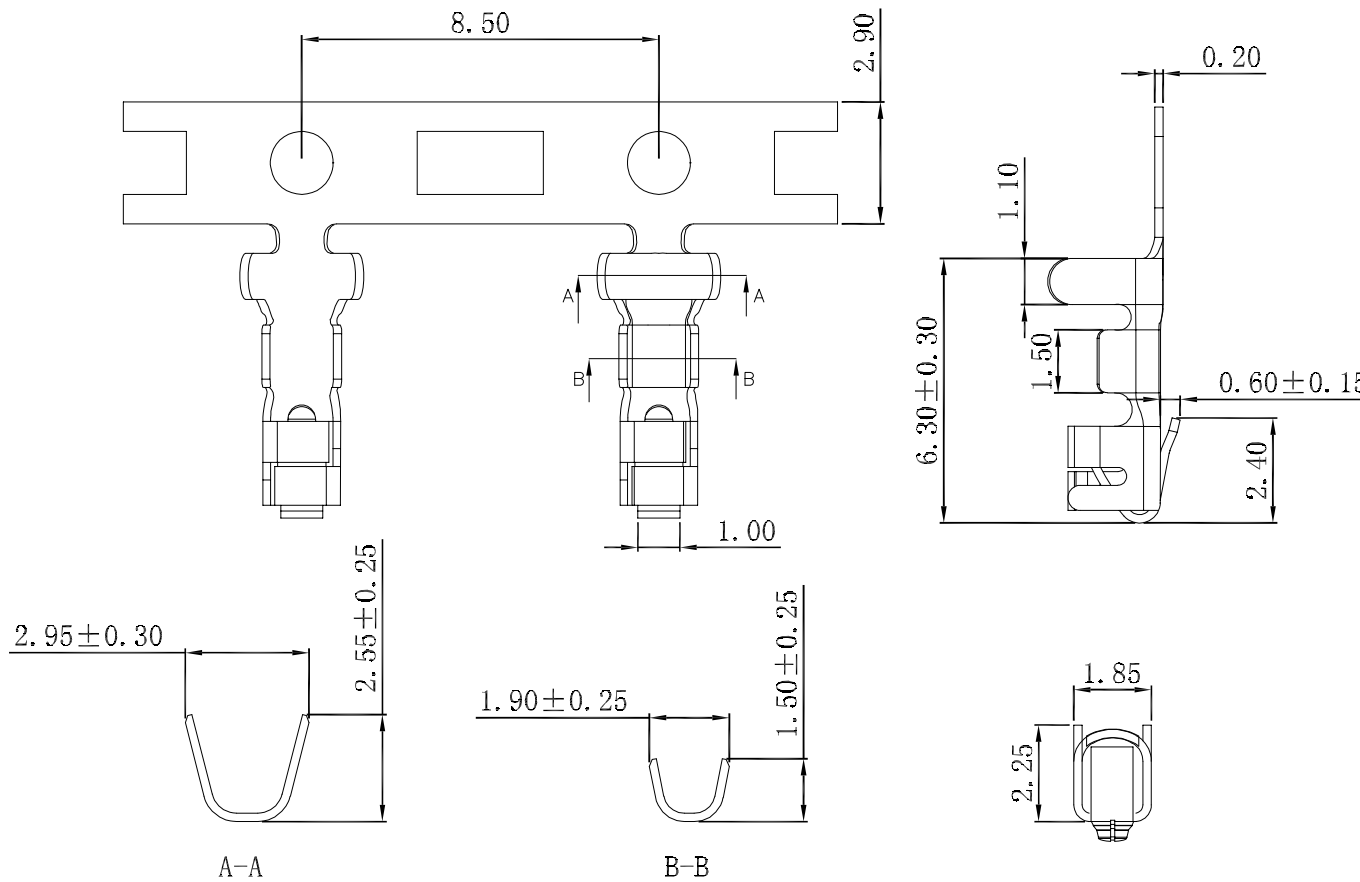

							General Tolerance	Zeakka Electronics				Document No.: ZK-2501TF					
							.X ±0.3					APPR CH'K DRWN Date Kai Lee Cris Wang Jun Wei 2020.8.8			Title: TERMINAL, FEMALE, CRIMP TYPE, PHOSPHOR BRONZE, TIN, REEL		
							.XX ±0.2								Dimensions	Scale	Version
							.XXX ±0.1								mm	1:1	A
Date	Version	EC No.	Description	DRWN	CH'K	APPR	THIRD ANGLE PROJECTION										

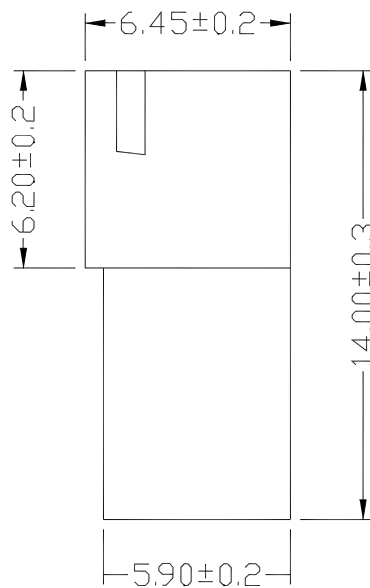
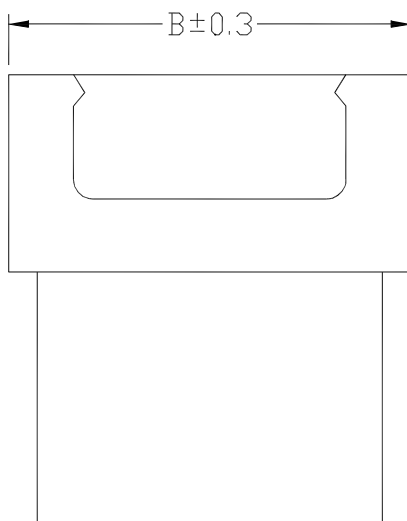
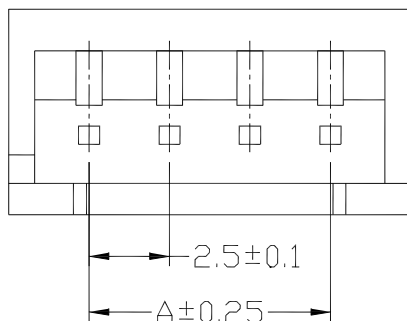

Circuits	Dimensions (mm)	
	A	B
2	2.50	7.50
3	5.00	10.00
4	7.50	12.50
5	10.00	15.00
6	12.50	17.50
7	15.00	20.00
8	17.50	22.50
9	20.00	25.00
10	22.50	27.50
11	25.00	30.00
12	27.50	32.50
13	30.00	35.00
14	32.50	37.50
15	35.00	40.00
16	37.50	42.50
17	40.00	45.00
18	42.50	47.50
19	45.00	50.00
20	47.50	52.50

Specifications:

Current Rating: 3.0A AC/DC
 Voltage rating: 250V AC/DC
 Temperature range: -25°C to +85°C
 Contact resistance: 20mΩ max.
 Insulation resistance: 1000MΩ min.
 Withstand voltage: 1000V AC/minute

Material:

Housing: nylon 66, UL94V-0, white

Mates with: 2501WF (wire connector, female)

Used with: 2501TM-PT (male terminal)

Part Number Information:

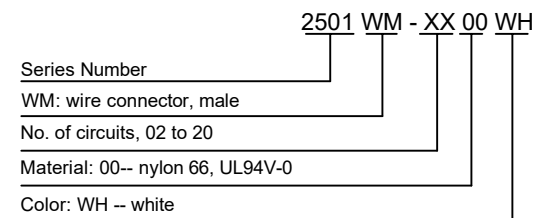

							General Tolerance	<h1>Zeakka Electronics</h1>				Document No.: ZK-2501WM		
							.X ±0.3					Title: HOUSING, MALE, CRIMP TYPE, SINGLE ROW, 2.5MM PITCH		
							.XX ±0.2	APPR	CH'K	DRWN	Date	Dimensions	Scale	Version
Date	Version	EC No.	Description	DRWN	CH'K	APPR	.XXX ±0.1	Kai Lee	Cris Wang	Jun Wei	2020.8.8	mm	1:1	A
							THIRD ANGLE PROJECTION							

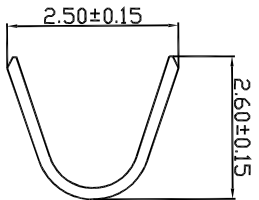
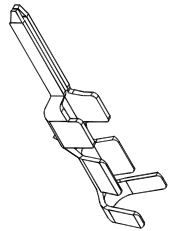
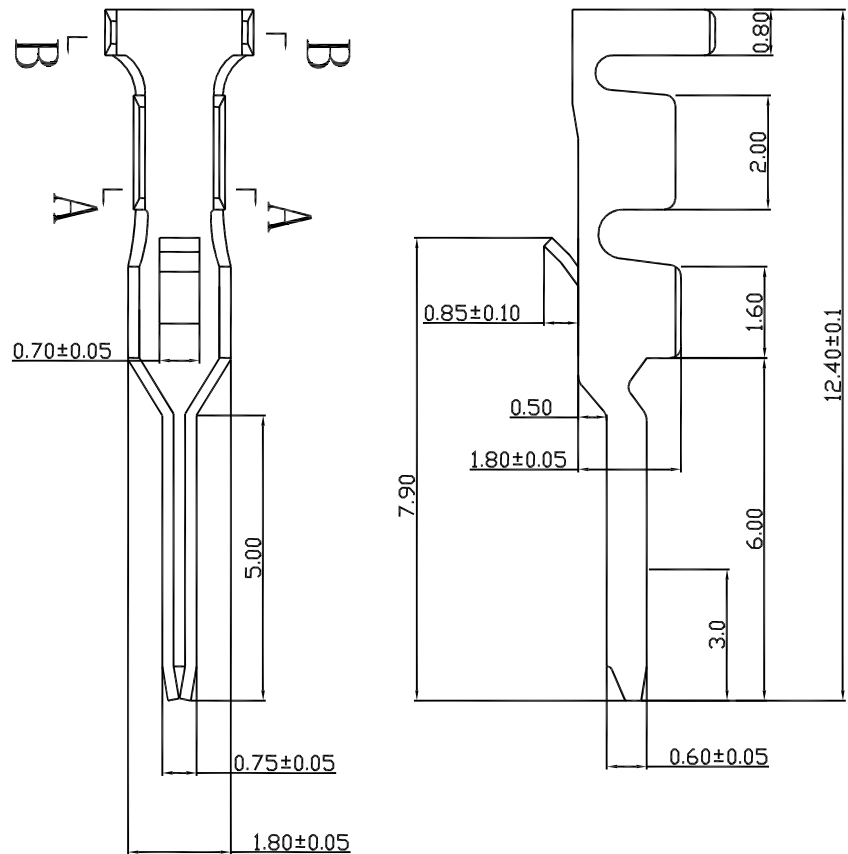

B-B

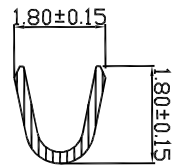

A-A

Specifications:

- Current Rating: 3.0A AC/DC
- Voltage rating: 250V AC/DC
- Temperature range: -25°C to +85°C
- Contact resistance: 20mΩ max.
- Insulation resistance: 1000MΩ min.
- Withstand voltage: 1000V AC/minute
- Applicable wire: AWG26 - AWG22
- Insulation OD: max 1.90mm

Material:

Phosphor bronze

Used with: 2501WM (male housing)

Part Number Information:

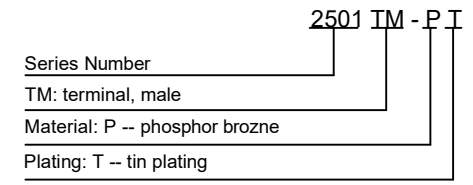

							General Tolerance	<h1>Zeakka Electronics</h1>				Document No.: ZK-2501TM						
							.X ±0.3					Title: TERMINAL, MALE, CRIMP TYPE, PHOSPHOR BRONZE, TIN, REEL						
							.XX ±0.2					APPR	CH'K	DRWN	Date	Dimensions	Scale	Version
							.XXX ±0.1					Kai Lee	Cris Wang	Jun Wei	2020.8.8	mm	1:1	A
Date	Version	EC No.	Description	DRWN	CH'K	APPR	THIRD ANGLE PROJECTION											