

P.C.B. LAYOUT

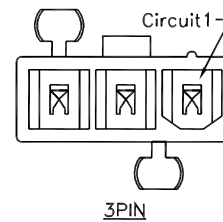
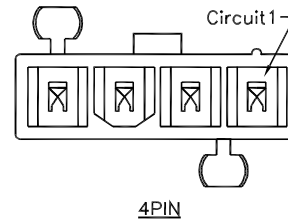
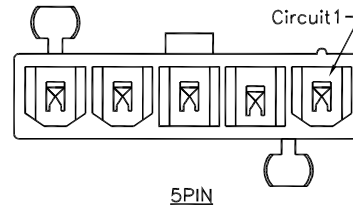
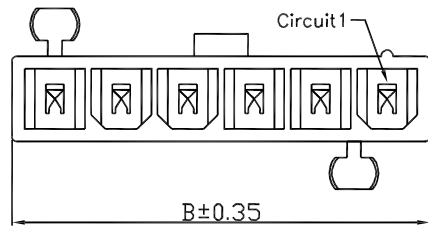
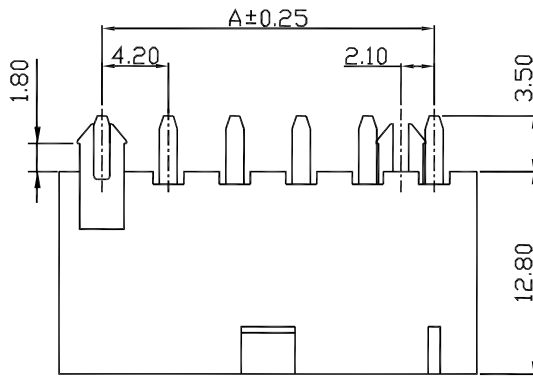
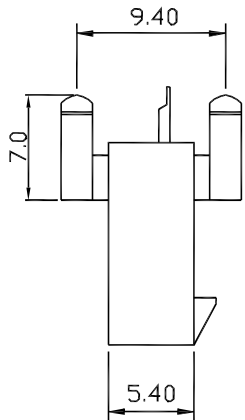

Specifications:

Current Rating: 9.0A AC/DC
 Voltage rating: 600V AC/DC
 Temperature range: -40°C to +105°C
 Contact resistance: 10mΩ max.
 Insulation resistance: 1000MΩ min.
 Withstand voltage: 1500V AC/minute

Circuits	Dimensions (mm)	
	A	B
3	8.40	13.80
4	12.60	18.00
5	16.80	22.20
6	21.00	26.40

Material:

Housing: nylon 66, UL94V-0/2, white / transparent white
 PIN: brass

Mates with: 4201WF-S (wire connector, female, single row)

Part Number Information:

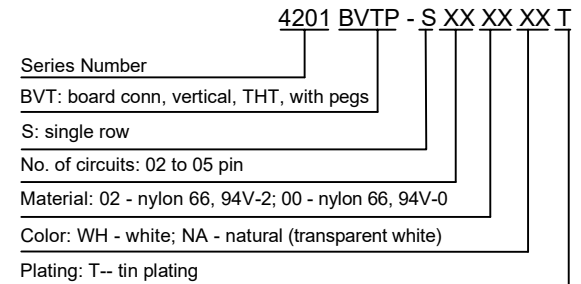

Date	Version	EC No.	Description	DRWN	CH'K	APPR	General Tolerance				Zeakka Electronics				Document No.:
							.X ±0.3	.XX ±0.2	.XXX ±0.1	APPR	CH'K	DRWN	Date	Dimensions	Scale
							THIRD ANGLE PROJECTION	Kai Lee	Cris Wang	Jun Wei	2020.8.8	mm	1:1	A	Title: HEADER, VERTICAL, THT TYPE, SINGLE ROW, 4.2MM PITCH, TIN

Circuits	Dimensions (mm)	
	A	B
2	4.20	9.60
3	8.40	13.80
4	12.60	18.00
5	16.80	22.20
6	21.00	26.40

Specifications:

Current Rating: 9.0A AC/DC
Voltage rating: 600V AC/DC
Temperature range: -40°C to +105°C
Contact resistance: 10mΩ max.
Insulation resistance: 1000MΩ min.
Withstand voltage: 1500V AC/minute

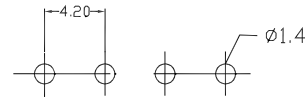

P.C.B. LAYOUT

Material:

Housing: nylon 66, UL94V-0/2, white / transparent white
PIN: brass

Mates with: 4201WF-S (wire connector, female, single row)

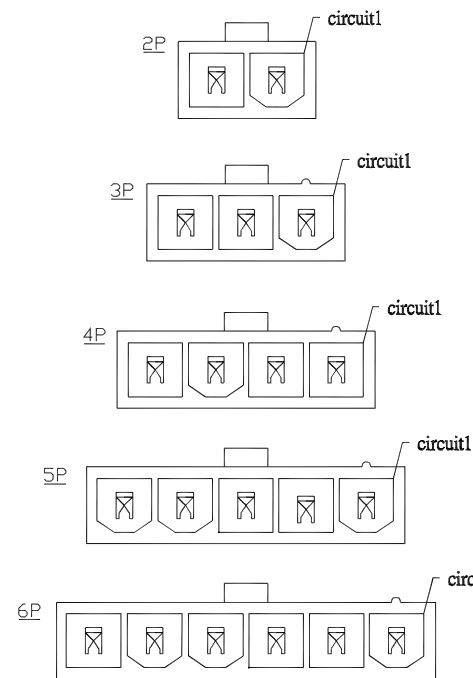
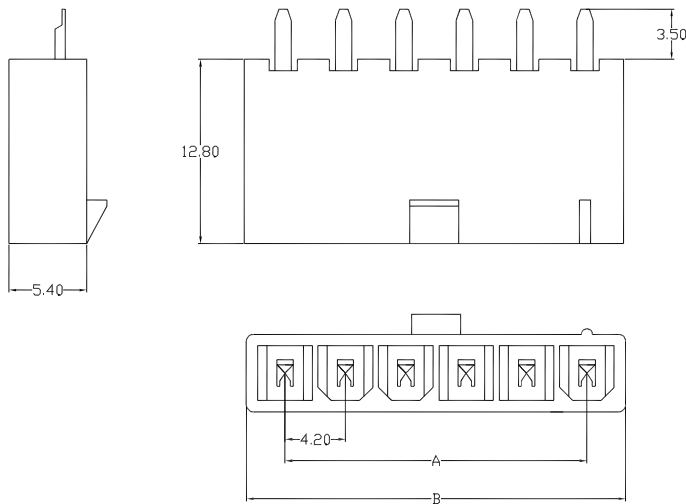

Part Number Information:

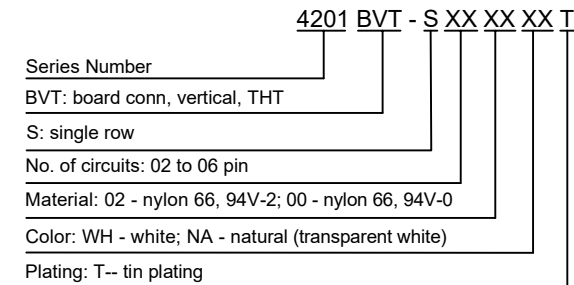

							General Tolerance	Zeakka Electronics				Document No.: ZK-4201BVT-S		
							.X ±0.3					Title: HEADER, VERTICAL, THT TYPE, SINGLE ROW, 4.2MM PITCH, TIN		
							.XX ±0.2	APPR	CH'K	DRWN	Date	Dimensions	Scale	Version
Date	Version	EC No.	Description	DRWN	CH'K	APPR	.XXX ±0.1	Kai Lee	Cris Wang	Jun Wei	2020.8.8	mm	1:1	A
							THIRD ANGLE PROJECTION							

Circuits	Dimensions (mm)	
	A	B
2	4.20	9.60
3	8.40	13.80
4	12.60	18.00
5	16.80	22.20
6	21.00	26.40

Specifications:

Current Rating: 9.0A AC/DC
Voltage rating: 600V AC/DC
Temperature range: -40°C to +105°C
Contact resistance: 10mΩ max.
Insulation resistance: 1000MΩ min.
Withstand voltage: 1500V AC/minute

Material:

Housing: nylon 66, UL94V-0/2, white / transparent white
PIN: brass

Mates with: 4201WF-S (wire connector, female, single row)

Part Number Information:

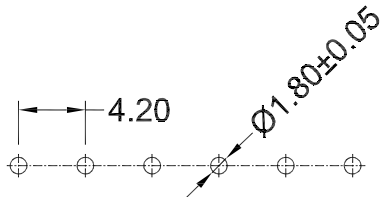
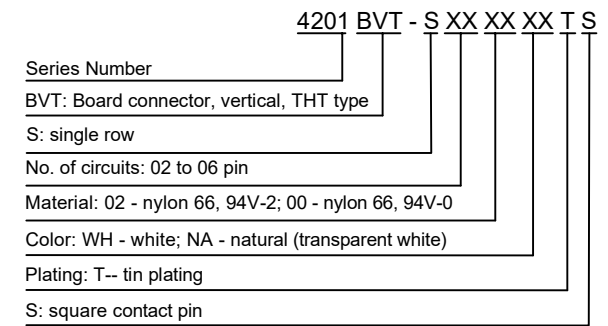

P.C.B LAYOUT

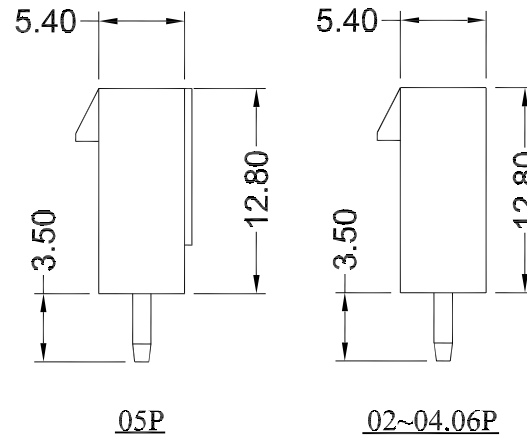
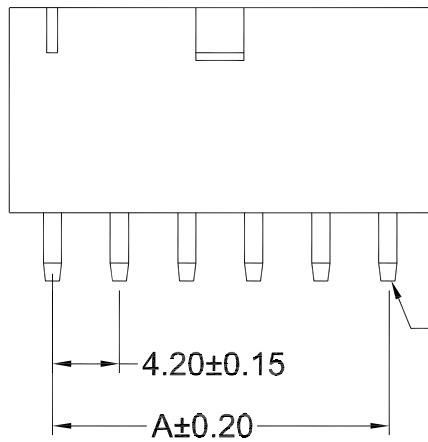
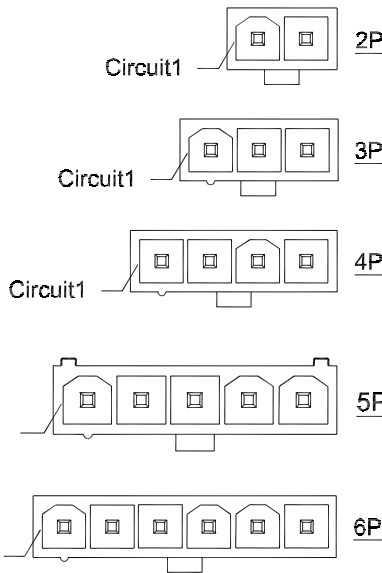
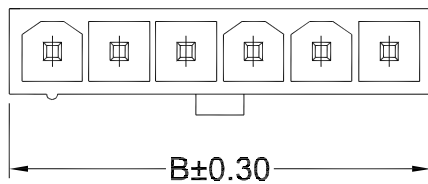

							General Tolerance	Zeakka Electronics				Document No.: ZK-4201BVT-SXXXXXXXTS		
							.X ±0.3					Title: HEADER, VERTICAL, THT TYPE, SINGLE ROW, 4.2MM PITCH, TIN		
							.XX ±0.2	APPR	CH'K	DRWN	Date	Dimensions	Scale	Version
Date	Version	EC No.	Description	DRWN	CH'K	APPR	.XXX ±0.1	Kai Lee	Cris Wang	Jun Wei	2020.8.8	mm	1:1	A
							THIRD ANGLE PROJECTION							

Circuits	Dimensions (mm)	
	A	B
2	4.20	9.90
3	8.40	14.10
4	12.60	18.30
5	16.80	22.50

Specifications:

Current Rating: 9.0A AC/DC
Voltage rating: 600V AC/DC
Temperature range: -40°C to +105°C
Contact resistance: 10mΩ max.
Insulation resistance: 1000MΩ min.
Withstand voltage: 1500V AC/minute

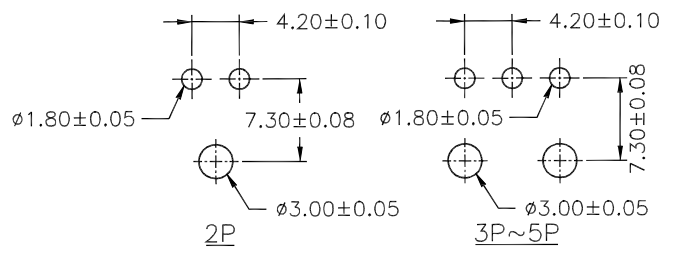
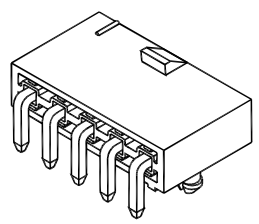

P.C.B LAYOUT

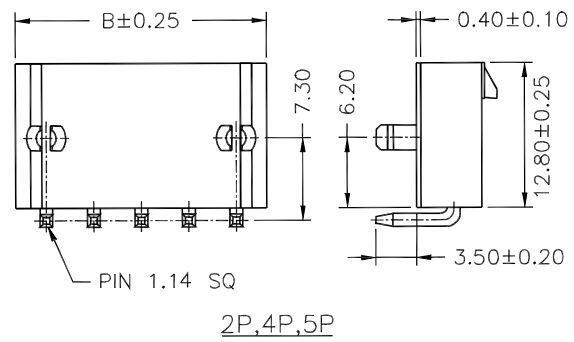
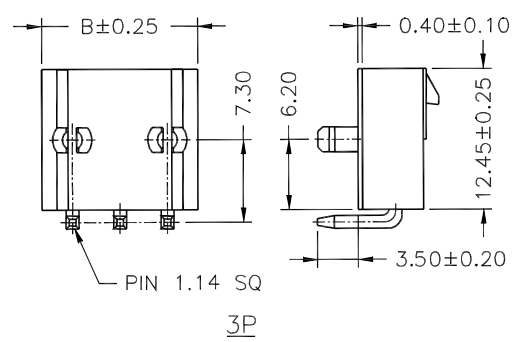
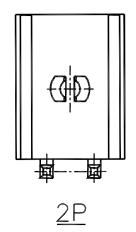
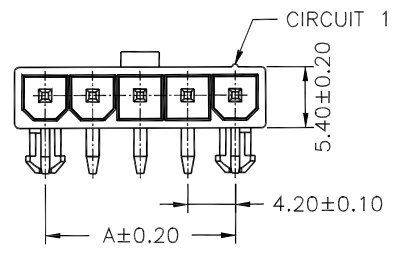
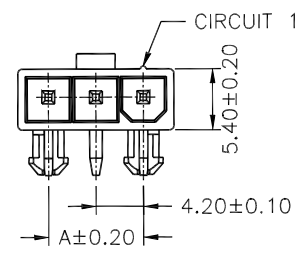

Material:

Housing: nylon 66, UL94V-0/2, white / transparent white
PIN: brass

Mates with: 4201WF-S (wire connector, female, single row)

Part Number Information:

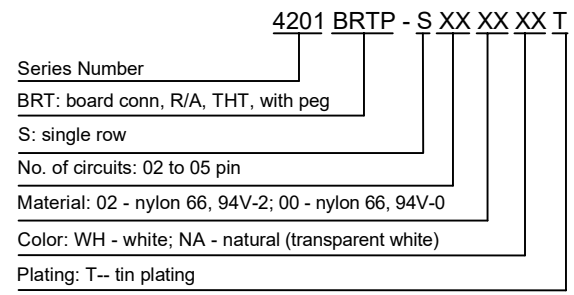

Date	Version	EC No.	Description	DRWN	CH'K	APPR	General Tolerance	Zeakka Electronics				Document No.:	ZK-4201BRTP-S		
							.X ±0.3	APPR	CH'K	DRWN	Date	Title: HEADER, R/A, THT TYPE, SINGLE ROW, 4.2MM PITCH, TIN			
						.XX ±0.2	Dimensions					Scale	Version		
						.XXX ±0.1	mm					1:1	A		
							THIRD ANGLE PROJECTION	Kai Lee	Cris Wang	Jun Wei	2020.8.8				

Circuits	Dimensions (mm)	
	A	B
2	4.20	9.60
3	8.40	13.80
4	12.60	18.00
5	16.80	22.20
6	21.00	26.40

Specifications:

Current Rating: 9.0A AC/DC
Voltage rating: 600V AC/DC
Temperature range: -40°C to +105°C
Contact resistance: 10mΩ max.
Insulation resistance: 1000MΩ min.
Withstand voltage: 1500V AC/minute

Material:

Housing: nylon 66, UL94V-0/2, white / transparent white
PIN: brass

Mates with: 4201WF-S (wire connector, female, single row)

Part Number Information:

4201 BRT - S XX XX XX T

Series Number
BRT: Board connector, R/A, THT type
S: single row
No. of circuits: 02 to 06 pin
Material: 02 - nylon 66, 94V-2; 00 - nylon 66, 94V-0
Color: WH - white; NA - natural (transparent white)
Plating: T-- tin plating

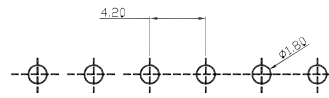

P.C.B LAYOUT

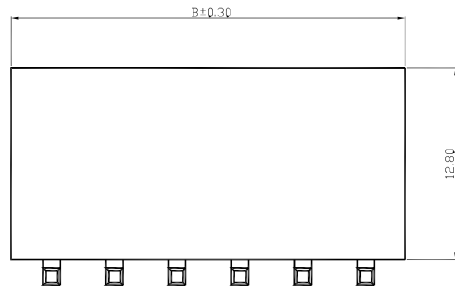
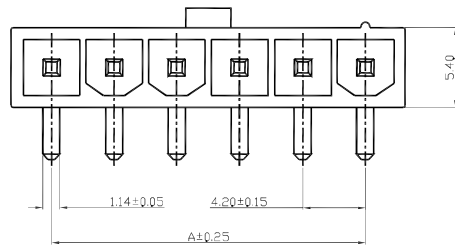
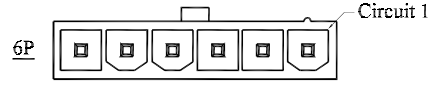
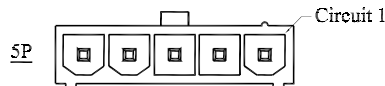
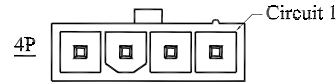
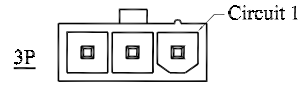
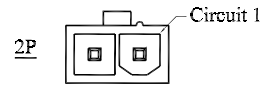
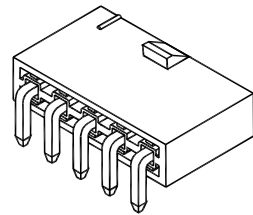

2~4PIN&6PIN

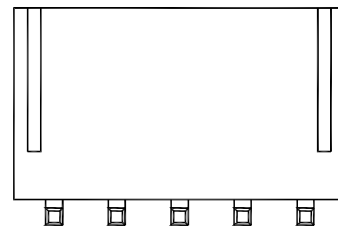
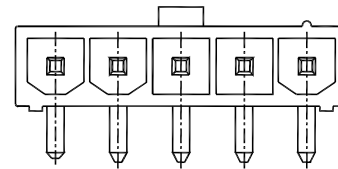
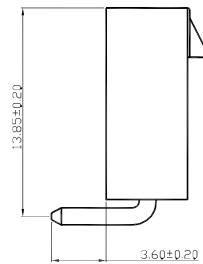

5PIN: with ribs

General Tolerance

.X ±0.3

.XX ±0.2

.XXX ±0.1

THIRD ANGLE PROJECTION

Zeakka Electronics

APPR

CH'K

DRWN

Date

Kai Lee

Cris Wang

Jun Wei

2020.8.8

Document No.: ZK-4201BRT-S

Title: HEADER, R/A, THT TYPE, SINGLE ROW, 4.2MM PITCH, TIN

Dimensions

Scale

Version

Date

Version

EC No.

Description

DRWN

CH'K

APPR

mm

1:1

A

Circuits	Dimensions (mm)		
	A	B	C
2	4.20	9.60	7.50
3	8.40	13.80	11.60
4	12.60	18.00	15.80
5	16.80	22.20	20.20
6	21.00	26.40	24.10

Specifications:

Current Rating: 9.0A AC/DC
Voltage rating: 600V AC/DC
Temperature range: -40°C to +105°C
Contact resistance: 10mΩ max.
Insulation resistance: 1000MΩ min.
Withstand voltage: 1500V AC/minute

Material:

Housing: nylon 66, UL94V-0/2, white / transparent white

Used with:

4201TF-XX (female terminal)
4201TFH-XX (female terminal, high crimp height)

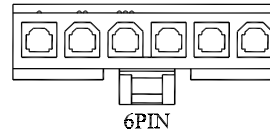
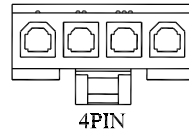
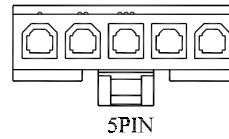
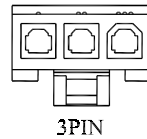
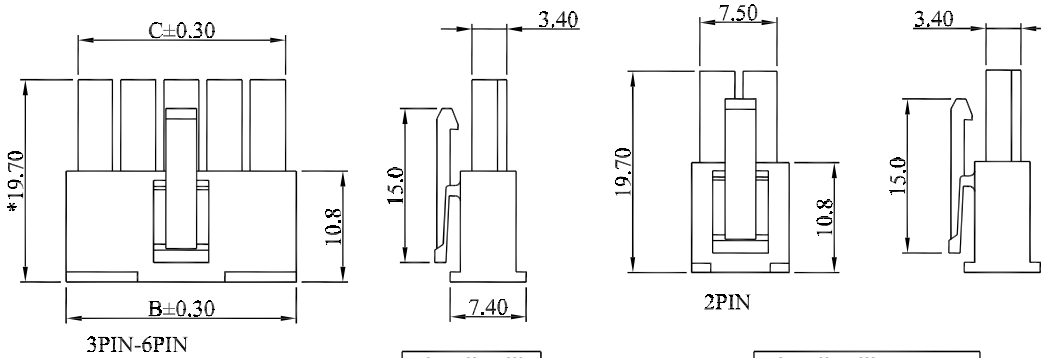
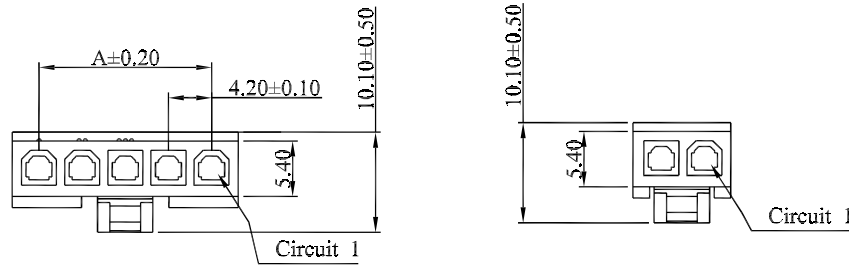
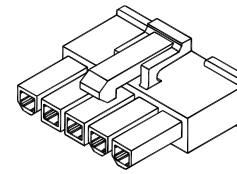

Part Number Information:

4201 WF - S XX XX XX

Series Number
WF: wire connector, female
S: single row
No. of circuits: 02 to 06 pin
Material: 02 - nylon 66, 94V-2; 00 - nylon 66, 94V-0
Color: WH - white; NA - natural (transparent white)

Date	Version	EC No.	Description	DRWN	CH'K	APPR	General Tolerance	Zeakka Electronics				Document No.:	ZK-4201WF-S		
							.X ±0.3	APPR	CH'K	DRWN	Date	Title:	HOUSING, FEMALE, CRIMP TYPE, SINGLE ROW, 4.2MM PITCH		
							.XX ±0.2					Dimensions	Scale	Version	
							.XXX ±0.1	Kai Lee	Cris Wang	Jun Wei	2020.8.8	mm	1:1	A	

THIRD ANGLE PROJECTION

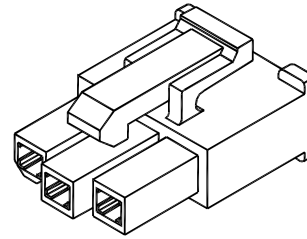

Specifications:

Current Rating: 9.0A AC/DC
 Voltage rating: 600V AC/DC
 Temperature range: -40°C to +105°C
 Contact resistance: 10mΩ max.
 Insulation resistance: 1000MΩ min.
 Withstand voltage: 1500V AC/minute

Material:

Housing: nylon 66, UL94V-0/2, white / transparent white

Used with:

4201TF-XX (female terminal)
 4201TFH-XX (female terminal, high crimp height)

Part Number Information:

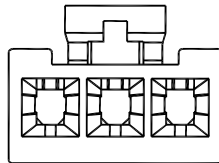
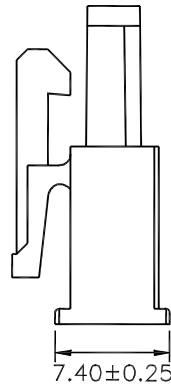
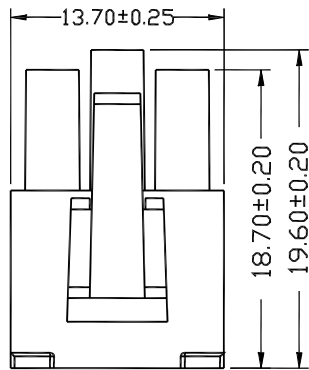
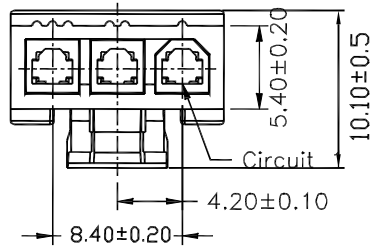
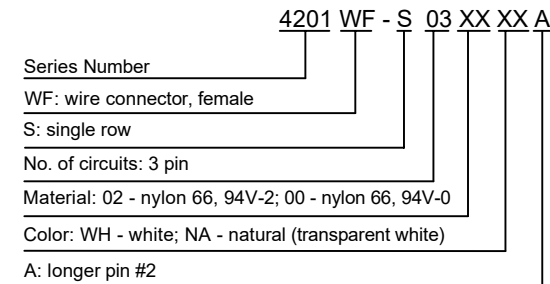

							General Tolerance	<h1>Zeakka Electronics</h1>				Document No.: ZK-4201WF-S03XXXX-1		
							.X ±0.3					APPR Kai Lee CH'K Cris Wang DRWN Jun Wei Date 2020.8.8 Title: HOUSING, FEMALE, CRIMP TYPE, SINGLE ROW, 4.2MM PITCH, 3 PIN Dimensions mm Scale 1:1 Version A		
							.XX ±0.2							
							.XXX ±0.1							
Date	Version	EC No.	Description	DRWN	CH'K	APPR	THIRD ANGLE PROJECTION	APPR	CH'K	DRWN	Date	Dimensions	Scale	Version

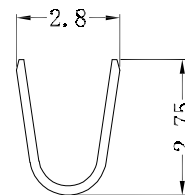
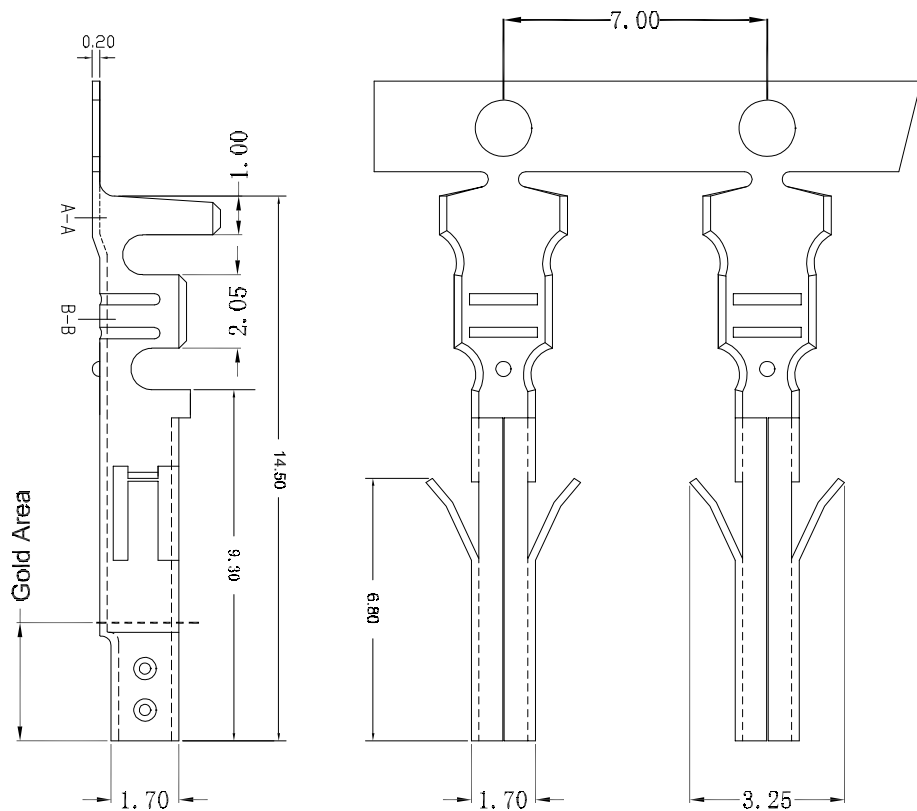

A-A

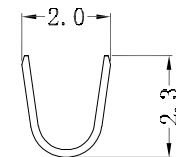

B-B

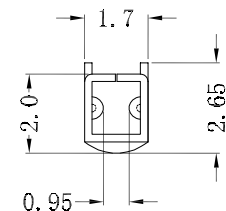

Specifications:

Current Rating: 9.0A AC/DC
 Voltage rating: 600V AC/DC
 Temperature range: -40°C to +105°C
 Contact resistance: 10mΩ max.
 Insulation resistance: 1000MΩ min.
 Withstand voltage: 1500V AC/minute
 Applicable wire: AWG22 - AWG18
 Insulation OD: max 3.0mm
 Package: reel

Material:

Phosphor bronze

Used with:

4201WF-S (wire connector, female, single row)
 4201WF-D (wire connector, female, dual row)

Part Number Information:

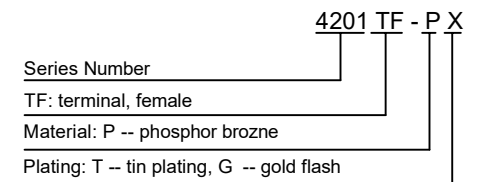

							General Tolerance	Zeakka Electronics				Document No.: ZK-4201TF-PX						
							.X ±0.3					Title: TERMINAL, FEMALE, CRIMP TYPE, PHOSPHOR BRONZE, REEL						
							.XX ±0.2					APPR	CH'K	DRWN	Date	Dimensions	Scale	Version
							.XXX ±0.1					Kai Lee	Cris Wang	Jun Wei	2020.8.8	mm	1:1	A
Date	Version	EC No.	Description	DRWN	CH'K	APPR	THIRD ANGLE PROJECTION											

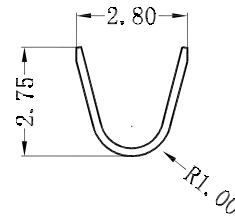
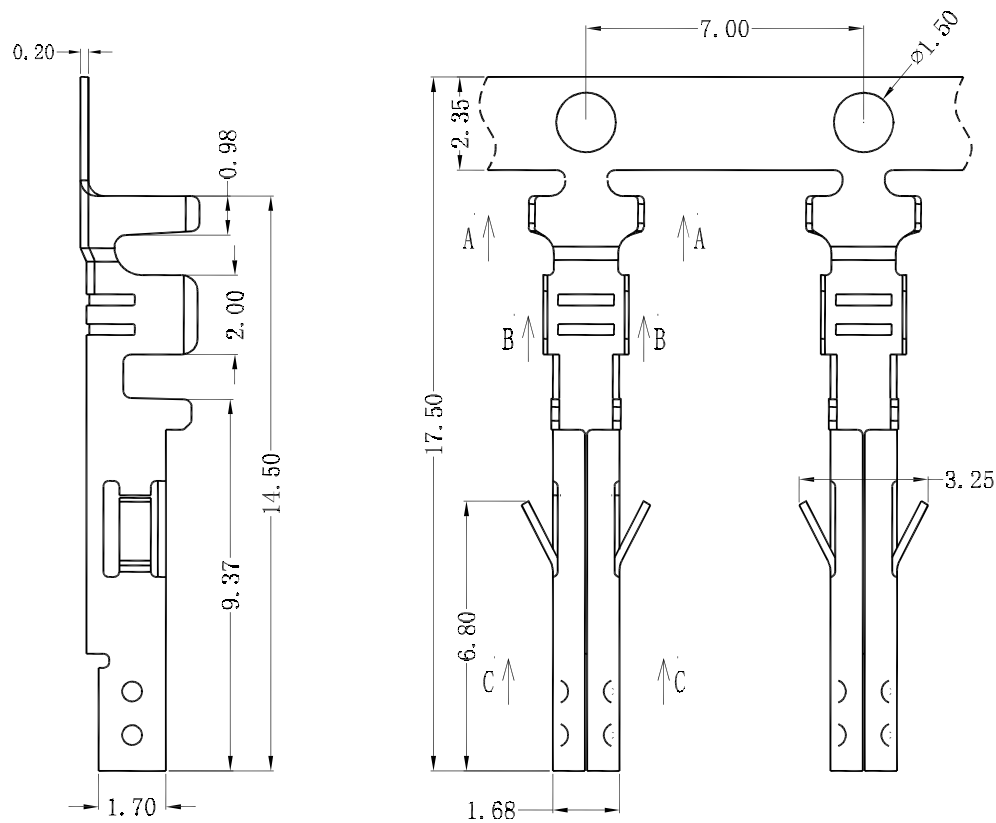

Section A-A

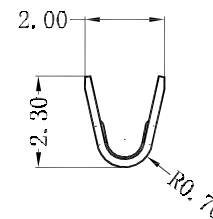

Section B-B

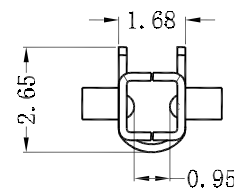

Section C-C

Specifications:

Current Rating: 9.0A AC/DC
 Voltage rating: 600V AC/DC
 Temperature range: -40°C to +105°C
 Contact resistance: 10mΩ max.
 Insulation resistance: 1000MΩ min.
 Withstand voltage: 1500V AC/minute
 Applicable wire: AWG22 - AWG18
 Insulation OD: max 3.0mm
 Package: reel

Material:

Brass

Used with:

4201WF-S (wire connector, female, single row)
 4201WF-D (wire connector, female, dual row)

Part Number Information:

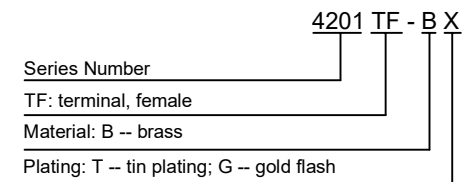

							General Tolerance	Zeakka Electronics				Document No.: ZK-4201TF-BX						
							.X ±0.3					Title: TERMINAL, FEMALE, CRIMP TYPE, BRASS, REEL						
							.XX ±0.2					APPR	CH'K	DRWN	Date	Dimensions	Scale	Version
							.XXX ±0.1					Kai Lee	Cris Wang	Jun Wei	2020.8.8	mm	1:1	A
Date	Version	EC No.	Description	DRWN	CH'K	APPR	THIRD ANGLE PROJECTION											

Circuits	Dimensions (mm)	
	A	B
2	4.20	9.70
3	8.40	13.90
4	12.60	18.10
5	16.80	22.30
6	21.00	26.50

Specifications:

Current Rating: 9.0A AC/DC
Voltage rating: 600V AC/DC
Temperature range: -40°C to +105°C
Contact resistance: 10mΩ max.
Insulation resistance: 1000MΩ min.
Withstand voltage: 1500V AC/minute

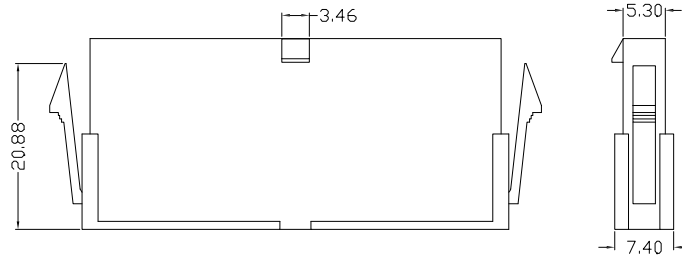

Material:

Housing: nylon 66, UL94V-0/2, white / transparent white

Used with: 4201TM-XX (male terminal)
4201TMH-XX (male terminal, high crimp height)

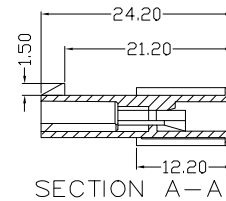
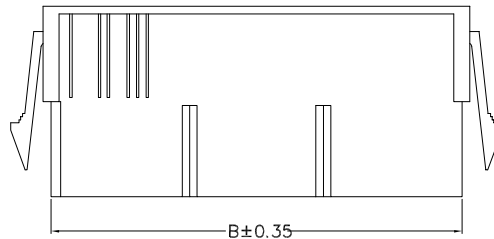
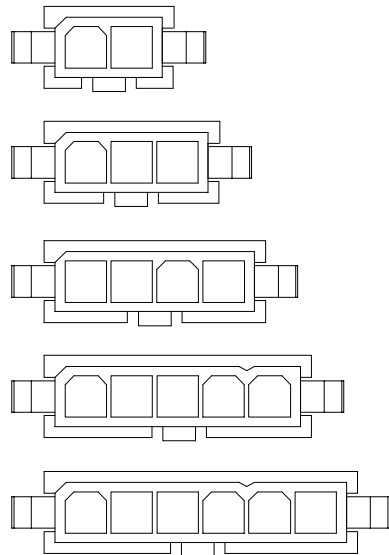
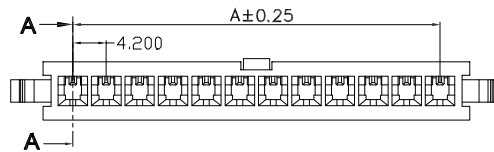

Part Number Information:

4201 WME - S XX XX XX

Series Number
WME: wire connector, male, with ears
S: single row
No. of circuits: 02 to 06 pin
Material: 02 - nylon 66, 94V-2; 00 - nylon 66, 94V-0
Color: WH - white; NA - natural (transparent white)

							General Tolerance	Zeakka Electronics				Document No.: ZK-4201WME-S		
							.X ±0.3					Title: HOUSING, MALE, CRIMP TYPE, SINGLE ROW, WITH EARS, 4.2MM PITCH		
							.XX ±0.2	APPR	CH'K	DRWN	Date	Dimensions	Scale	Version
Date	Version	EC No.	Description	DRWN	CH'K	APPR	.XXX ±0.1	Kai Lee	Cris Wang	Jun Wei	2020.8.8	mm	1:1	A
							THIRD ANGLE PROJECTION							

Circuits	Dimensions (mm)	
	A	B
2	4.20	9.80
3	8.40	14.00
4	12.60	18.20
5	16.80	22.40
6	21.00	26.60

Specifications:

Current Rating: 9.0A AC/DC
Voltage rating: 600V AC/DC
Temperature range: -40°C to +105°C
Contact resistance: 10mΩ max.
Insulation resistance: 1000MΩ min.
Withstand voltage: 1500V AC/minute

Material:

Housing: nylon 66, UL94V-0/2, white / transparent white

Used with:

4201TM-XX (male terminal)
4201TMH-XX (male terminal, high crimp height)

Part Number Information:

4201 WM - S XX XX XX

Series Number
WM: wire connector, male
S: single row
No. of circuits: 02 to 06 pin
Material: 02 - nylon 66, 94V-2; 00 - nylon 66, 94V-0
Color: WH - white; NA - natural (transparent white)

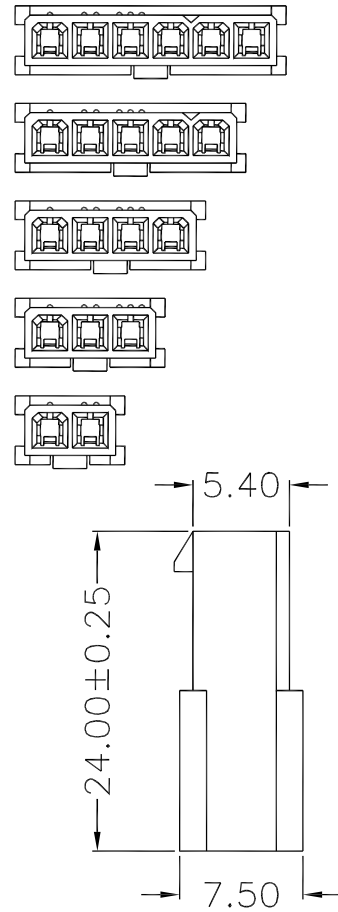
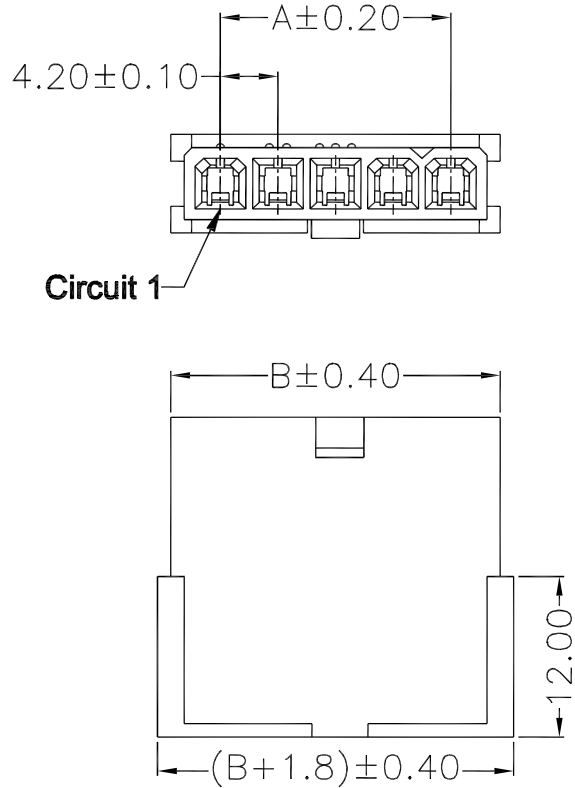

							General Tolerance	<h1>Zeakka Electronics</h1>				Document No.: ZK-4201WM-S		
							.X ±0.3					Title: HOUSING, MALE, CRIMP TYPE, SINGLE ROW, 4.2MM PITCH		
							.XX ±0.2							
Date	Version	EC No.	Description	DRWN	CH'K	APPR	.XXX ±0.1	Kai Lee	Cris Wang	Jun Wei	2020.8.8	mm	1:1	A

THIRD ANGLE PROJECTION

Specifications:

Current Rating: 9.0A AC/DC
 Voltage rating: 600V AC/DC
 Temperature range: -40°C to +105°C
 Contact resistance: 10mΩ max.
 Insulation resistance: 1000MΩ min.
 Withstand voltage: 1500V AC/minute
 Applicable wire: AWG22 - AWG16
 Package: reel

Material:

Phosphor bronze / Brass

Used with:

4201WM-S (wire connector, male, single row)
 4201WME-S (wire connector, male, with ears, single row)
 4201WM-D (wire connector, male, single row)
 4201WME-D (wire connector, male, with ears, single row)

Part Number Information:

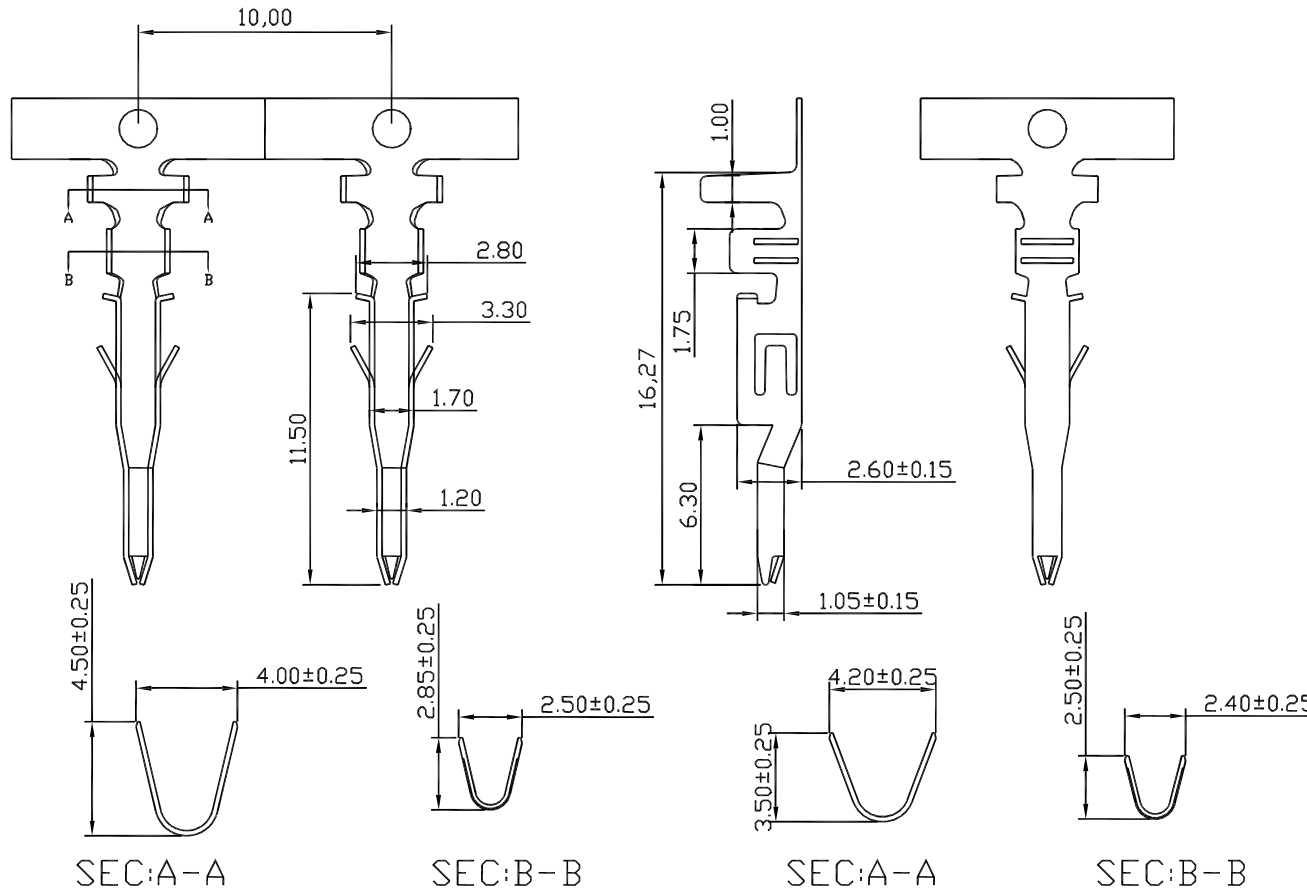
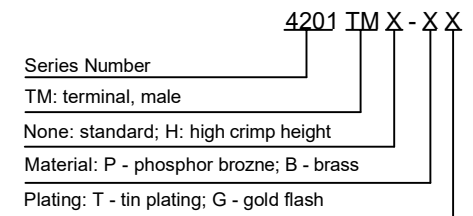

High crimp height
 For AWG #22 - #16
 Insulation OD: max 3.1mm

Standard
 For AWG #22 - #18
 Insulation OD: max 3.0mm

							General Tolerance	Zeakka Electronics				Document No.: ZK-4201TM						
							.X ±0.3					Title: TERMINAL, MALE, CRIMP TYPE, PHOSPHOR BRONZE / BRASS, REEL						
							.XX ±0.2					APPR	CH'K	DRWN	Date	Dimensions	Scale	Version
							.XXX ±0.1					Kai Lee	Cris Wang	Jun Wei	2020.8.8	mm	1:1	A
Date	Version	EC No.	Description	DRWN	CH'K	APPR	THIRD ANGLE PROJECTION											